

Survey Monument Record

CORNER NO. 28  
 SECTION 09  
 TOWN 2N  
 RANGE 1W

TYPE OF MONUMENT GRANT COUNTY Alum.  
Mon. Set

FIELD BOOK: 94-18  
 PAGE (11)

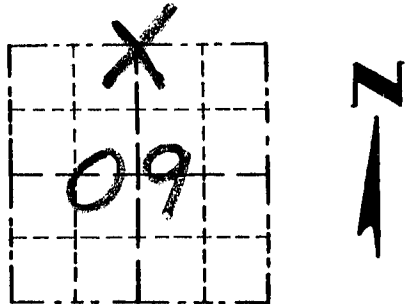

LOCATION  
 (Indicated by "X")

BASIS FOR MONUMENT LOCATION

(Use reverse side if necessary)

Show info such as: History of corner, with reference to Vol. and pg., dates, surveyor; exact description of monument replaced; if location computed, by taped or EDM traverse; landowner, remarks, etc.

CORNER SET IN 1832  
 BY LUCIUS LYON. NO RECORD  
 OF CORNER FOUND SINCE  
 ORIGINAL SURVEY; CORNER  
 WAS SET AT A OCCUPIED  
 FENCE CORNER. VERIFIED ITS  
 LOCATION USING EDM METHODS.

SEAL:

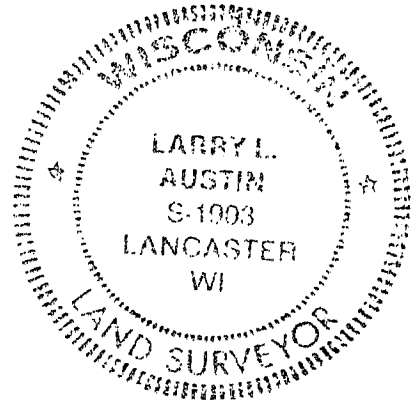

CERTIFIED CORRECT

*Larry L. Austin*  
 Registered Land Surveyor  
 DATE: 7/30/97

TIE SKETCH

Show at least three (3) ties and monument

LEGEND

- ⊕ GRANT COUNTY Alum. MON SET
- 1" x 12" IRON PIPES SET
- ×× EXISTING FENCE

