

# SECTION CORNER TIES

TO THE WEST 1/4 CORNER OF SECTION 12, TOWN 1 NORTH,  
RANGE 2 WEST, COUNTY OF DODGE, STATE OF WISCONSIN,  
TOWNSHIP, GRANT COUNTY, WISCONSIN.

I, Bruce D. Berman, hereby certify that I have  
complied with the provisions of the Statutes of the State  
of The United States and the rules and regulations  
of the Secretary of the Interior in the location  
of the corner the subject of this plat.

APPROVED: \_\_\_\_\_

*Bruce D. Berman*  
Surveyor



## LEGEND



4" x 4" iron nail in concrete foundation



1/4" iron nail in concrete foundation

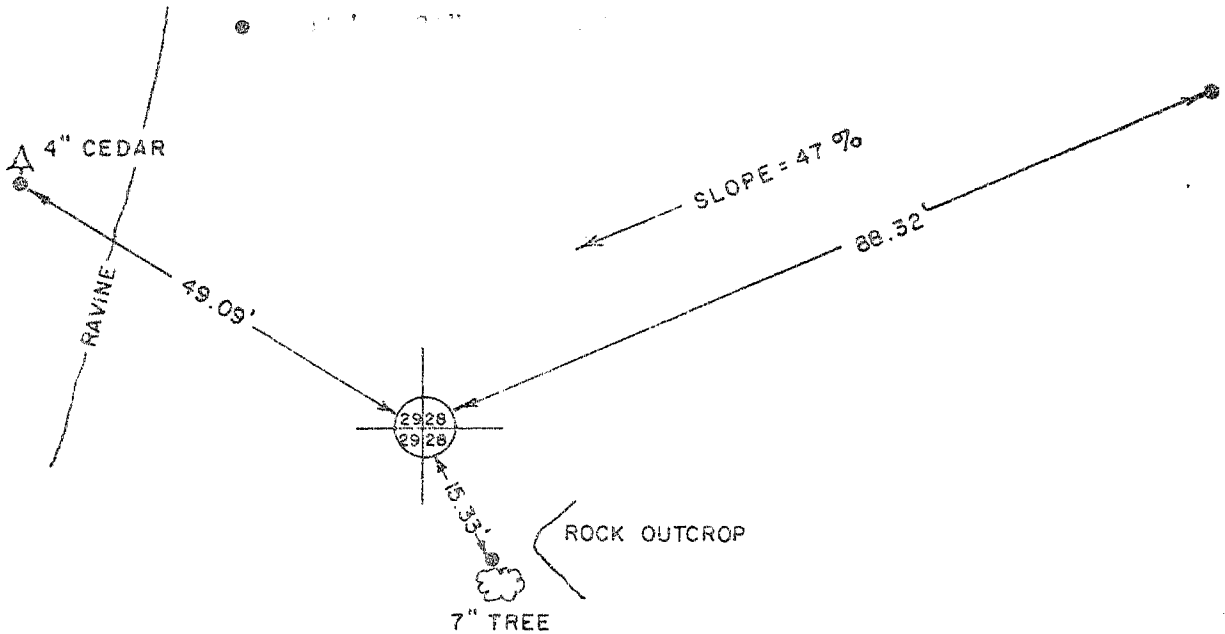

STATE PLANE COORDINATES: NORTH 193742.517  
EAST 1832157.655

BOOK D-1 PAGE 47  
JOB NO. D-78007  
CHECKED KSM  
DRAWN BY RJM

SCALE: 1" = 20'

**TALARCZYK & ASSOC., INC.**

110 E. Division Street  
DODGEVILLE, WI 53533

Phone 608/935-5301

*p-96*