

SECTION CORNER TIES

TO THE NORTHEAST CORNER OF SECTION 28, TOWN 1 NORTH,
RANGE 2 WEST, FOURTH PRINCIPLE MERIDIAN, JAMESTOWN
TOWNSHIP, GRANT COUNTY, WISCONSIN.



I, Bruce D. Bowden, hereby certify that I have complied with the Wisconsin Statutes, the Statutes of the United States and the rules and regulations of the Secretary of the Interior in the location of the corner shown below.

April 4, 1978

Bruce D. Bowden
Bruce D. Bowden R.L.S.-1250

Monument as established in a survey by David Krohn dated August 23, 1976.

STATE OF WISCONSIN
COUNTY OF GRANT
TOWNSHIP OF JAMESTOWN

LEGEND



4" CAST ALUMINUM WISC. DIV. OF HIGHWAYS MONUMENT FOUND. (0.3' ABOVE GRADE)



3/4" x 24" IRON ROD

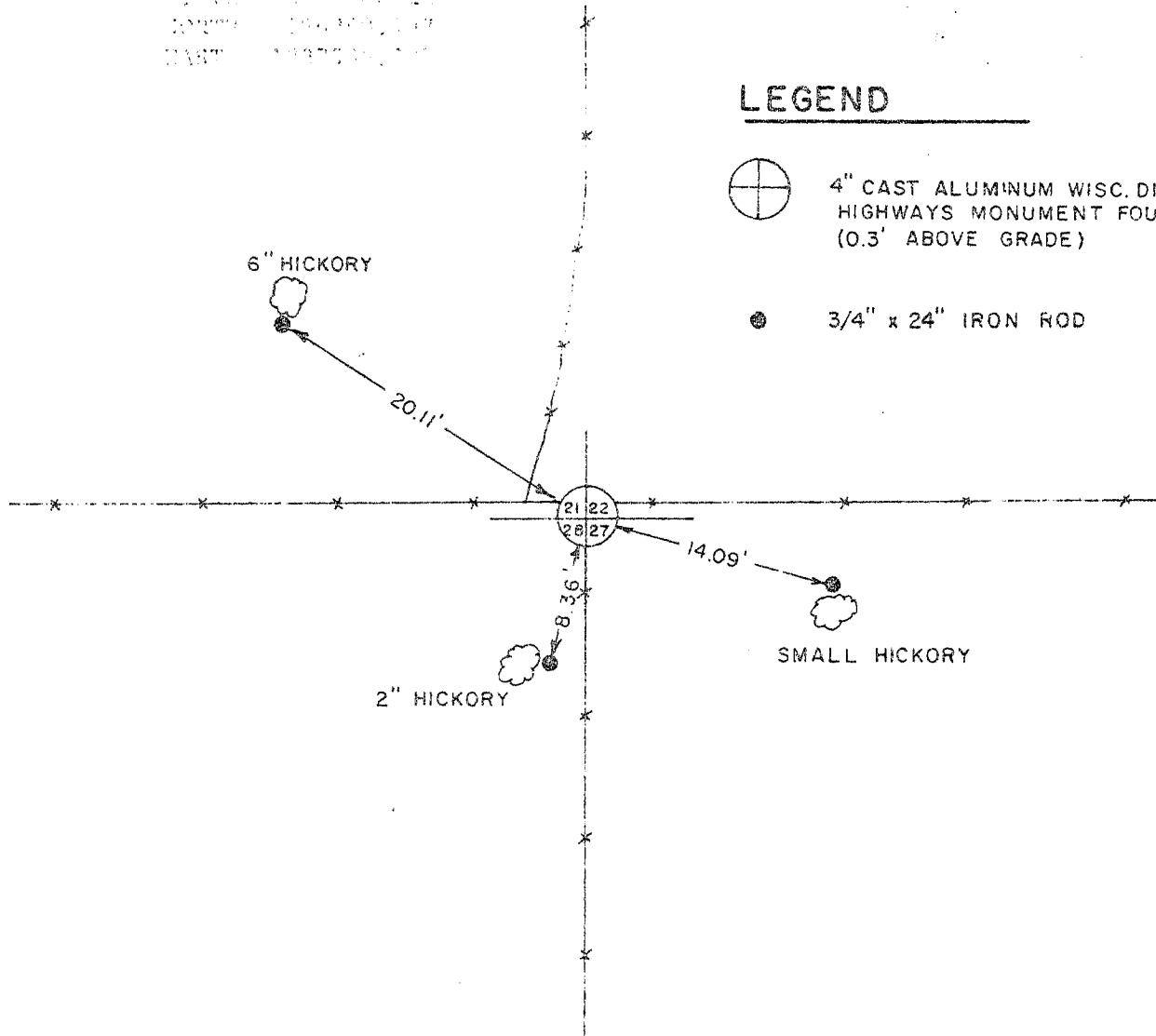

BOOK D-1 PAGE 47
JOB NO. D-78007
CHECKED RJM
DRAWN BY RJM

SCALE: 1" = 10'

TALARCZYK & ASSOC., INC.

110 E. Division Street
DODGEVILLE, WI 53533

Phone 608/935-5301

87