

Hazel Green Twp.

U.S. PUBLIC LAND SURVEY MONUMENT RECORD

AUG 7 1987

GRANT COUNTY, WISCONSIN

RECEIVED

SECTION 30 TOWNSHIP 1N RANGE 1W CORNER N¹/₄ NW FRAC.

EVIDENCE: Existing fence line east, west and north

MONUMENT: Found Placed

METHOD: Accepted Existing Location
Accepted Occupation
Lost Corner Porportionate Methods

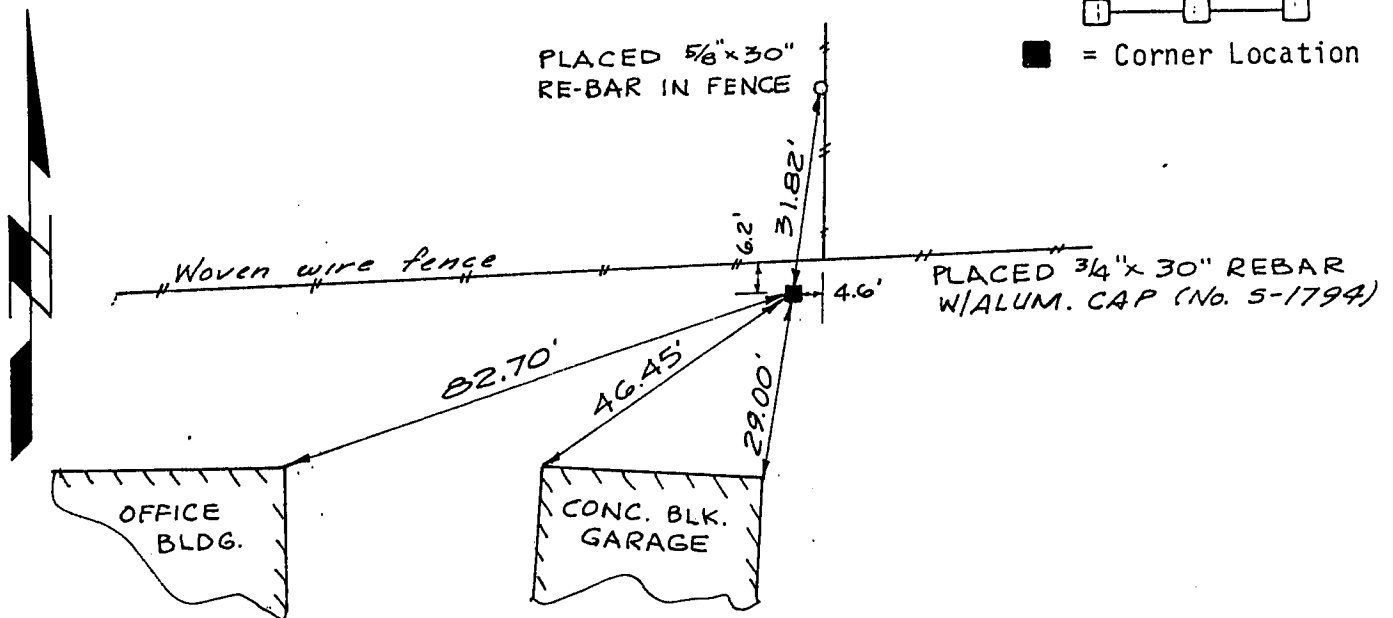
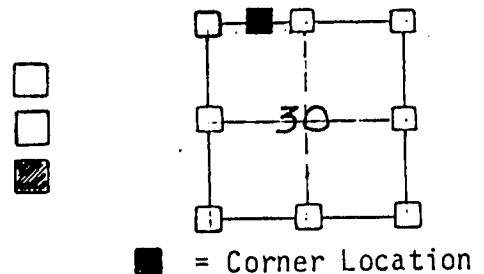

- LEGEND
- Government Corner
 - Existing Fence Lines
 - ⊗ Power Pole
 - Existing Iron Pipe as shown
 - Placed Rebar as shown

HISTORY & OTHER INFORMATION: This corner placed 1416.51 feet east of NW cor. sec.30 & 1329.44 feet west of N¹/₄ corner sec. 30, TIN, R1W, 4th P.M.

I, Ronald J. Turner, hereby certify that the corner location shown hereon this record was determined by me or under my direction and control and that this U.S. Public Land Survey Monument Record is correct and complete to the best of my knowledge and belief.



July 31, 1987
Date
Ronald J. Turner
Registered Land Surveyor
No. 5-1794

ASSOCIATES P.C.
3210 St. Joseph Dr., R.R. #2 • Dubuque, IA 52001 • (319) 588-2484
P.O. Box 275 • Galena, IL 61036 • (815) 777-0358

Title <u>Monument Record</u> <u>N¹/₄ of the NW¹/₄ Sec.30</u>		Sheet <u>1</u> of <u>1</u>
Date <u>7-31-87</u>	Scale <u>1"=30'</u>	Drawing No.
Drawn <u>R. J. T.</u>	Field Book <u>WI-1-87</u>	
Reviewed	Revision	

P. J. S.