

U. S. PUBLIC LAND SURVEY MONUMENT TIE SHEET - GRANT COUNTY WISCONSIN.

Section # 31 , Town 8 North, Range 2 West, Town of
Watterstown.

Certificate

I, Craig E Hardy, do hereby certify that the corner location on this record was determined by me and/or under my direct supervision and that this U.S. public land survey monument record is correct and complete to the best of my knowledge and belief.

Dated this 21st day of March, 2007.

Craig E Hardy
Craig E Hardy, WI-RLS #2304

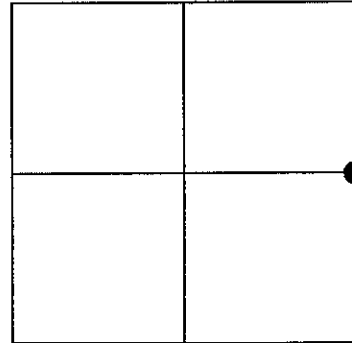

History of Corner Establishment

The original corner was set in 1833. No other records exist at the county tax office or county surveyor's office.

Description of Corner Evidence Found:

I found no evidence of the original corners beyond fence lines of occupation. I re-established this monument based on an extensive GPS and EDM survey of property fences in the section on lands owned by Doc Martin, Greg Johnson, Charles Baumeister, and Don Nelson.

Description of Corner and Witness Monuments, references and accessories used to perpetuate the original or re-established location of this corner.

Witnesses to corner location _____.

SKETCH:



Sketch - Not To Scale

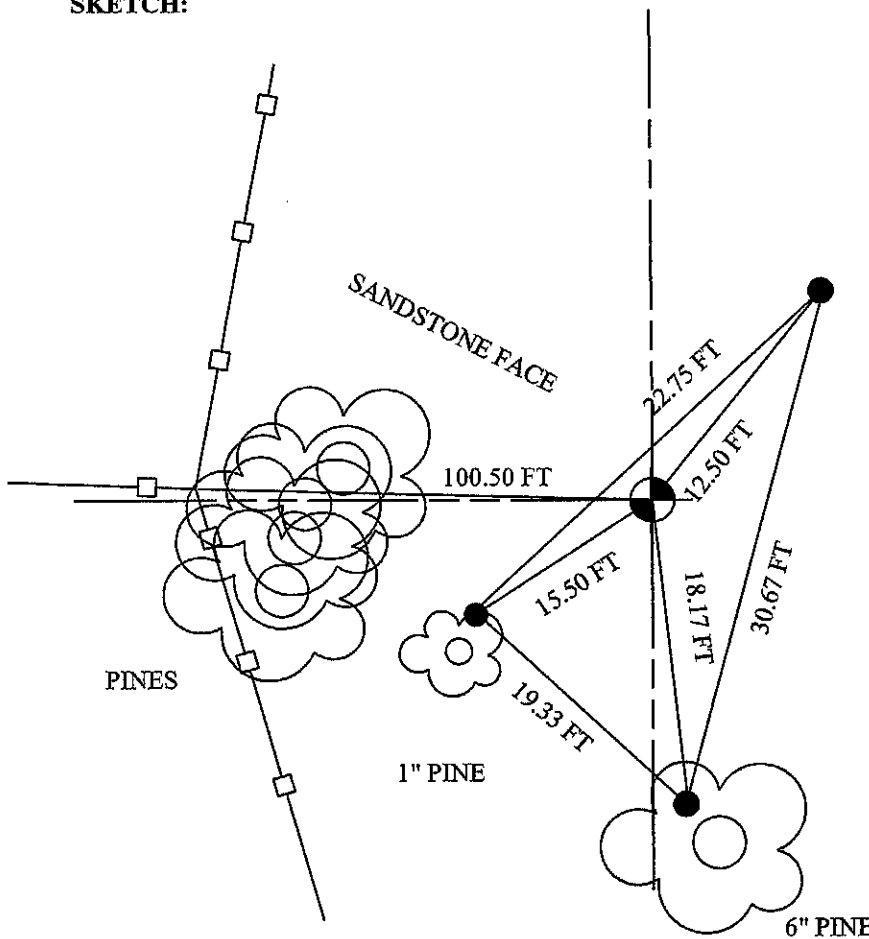

Legend



Set 1" dia. x 30" iron rebar w/ alum. cap
Set 1/2" dia. x 24" iron rebar

Corner Number - 115