

U. S. PUBLIC LAND SURVEY MONUMENT TIE SHEET - GRANT COUNTY WISCONSIN.

Section # 31 , Town 8 North, Range 2 West, Town of
Watterstown.

Certificate

I, Craig E Hardy, do hereby certify that the corner location on this record was determined by me and/or under my direct supervision and that this U.S. public land survey monument record is correct and complete to the best of my knowledge and belief.

Dated this 1st day of May, 2004.

Craig E Hardy
Craig E. Hardy, WI-RLS #2304

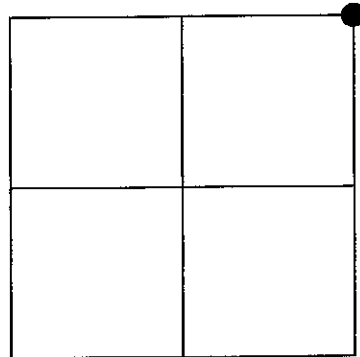

History of Corner Establishment

The original corner was set in 1833.

Description of Corner Evidence Found:

Found a 1-1/4" dia. iron pipe at the location of an old wooden fence post location. After an extensive GPS and EDM survey of the area, I accepted the location of the 1-1/4" rusty iron pipe and set a 1" dia. rebar with county aluminum cap inside of it.

Description of Corner and Witness Monuments, references and accessories used to perpetuate the original or re-established location of this corner.

Witnesses to corner location _____

SKETCH:



Sketch - Not To Scale

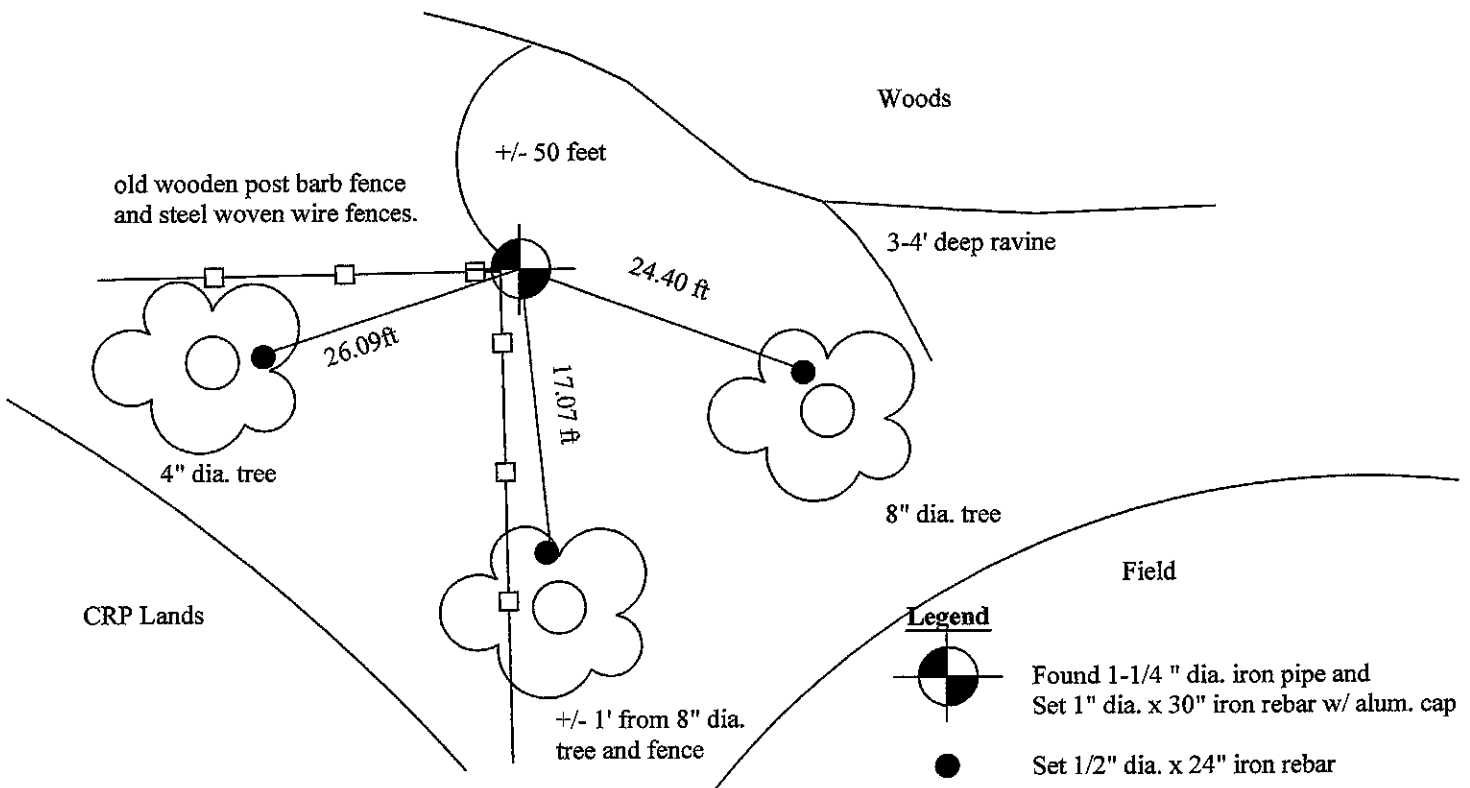

Legend

- Found 1-1/4" dia. iron pipe and Set 1" dia. x 30" iron rebar w/ alum. cap
- Set 1/2" dia. x 24" iron rebar

Corner Number - ____