

GRANT COUNTY

U.S. PUBLIC LAND SURVEY MONUMENT RECORD

TYPE OF MONUMENT: Stone Monument Found
TIES ARE AS INDICATED ON SKETCH

WITNESSES TO CORNER LOCATION

Sean M. Walsh
 Christopher G. Reedy

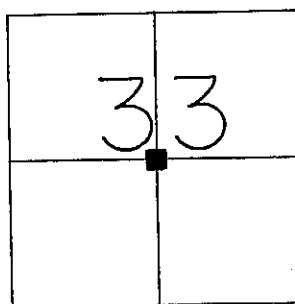
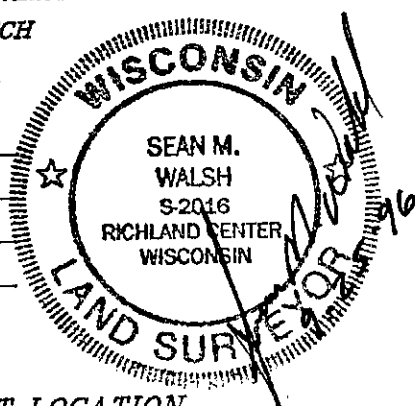

CORNER LOCATION
 Center 1/4 Corner
 Section 33, T8N, R1W
 Town of Muscoda

BASIS FOR MONUMENT LOCATION

Record evidence of this corner having been used by Joel Barber in 1880 at which time he referenced one tree and old stake, from Book "D", pg. 58

Subsequent record evidence of this corner having been used by Joel Barber again in 1880 for the subdivision of the Southeast One-quarter of Section 33 indicates no monumentation or ties taken, Book "D", pg. 73.

Mr. Lawrence Heffner, owner of lands lying north of the corner told me of a stone monument purported to be the quarter corner.

After having located this stone in an east / west fenceline, examining it and traversing the southeast quarter of Section 33, I have accepted and perpetuated it as shown hereon.

I, do hereby certify that this information is correct and true to the best of my knowledge, information and belief.

TIE SKETCH

- - Stone Monument at Corner
- - 3/4" X 24" Iron Rod Set as Tie and buried ±6"

Tie distances were measured horizontally by taping.

