

OCT 29 1987

# RECORD OF CORNER MONUMENTATION

W 1/4 CORNER, SECTION 27 TOWNSHIP 8 N., RANGE 1 WEST  
GRANT COUNTY, WISCONSIN.

STATE PLANE COORDINATES OF \_\_\_\_\_  
(Y) NORTH \_\_\_\_\_ ELEVATION \_\_\_\_\_  
(X) EAST \_\_\_\_\_

HORIZONTAL DATUM: WISCONSIN STATE PLANE COORDINATE SYSTEM, SOUTH ZONE



SKETCH OF CORNER REFERENCE TIES

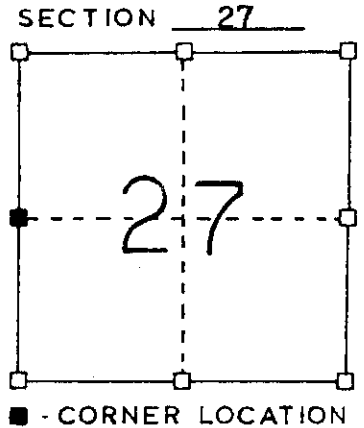

TYPE OF MONUMENT:

"STONE"

10"  $\emptyset$  W. Oak

WOODS

WOODS

7"  $\emptyset$  Maple

8"  $\emptyset$  W. Oak

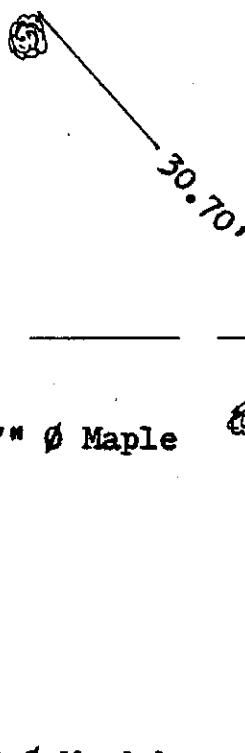

18"  $\emptyset$  W. Oak

7"  $\emptyset$  Maple

WOODS

WOODS

**NOTE:** All trees are blazed and marked with a 30d pole spike.

SURVEYOR'S CERTIFICATE  
(STATE OF WISCONSIN)

I HEREBY CERTIFY THAT a "stone" monument was located at the above position on October 12, 1987 by Terry L. Cornell and Tom D. Lawrence. The ties shown above were taken such that this location may be perpetuated.

DATED THIS 20<sup>th</sup> DAY OF October 1987

*Terry L. Cornell*  
REGISTERED LAND SURVEYOR  
S-1905



P-977