

**U.S. PUBLIC LAND SURVEY MONUMENT RECORD**

(As Required By s. A-E 7.08, WI Adm. Code)

History of original corner establishment and subsequent restorations and description of any record, monument, occupational, testimonial or other evidence considered: *The last survey record I found of this corner was from 1856. I computed the corner location on a line between the NW corner and at the same distance from the SW corner as measured in the SE 1/4. (2620.67'). I computed the north position at 1/2 the distance between the NW corner and a fence line near the SW corner (2637.58'). I found ancient type*

Corner was: (Check All That Apply) *buried wire north of the restored corner. See section summary for relationships to other corners.*

- Restored through acceptance of an obliterated evidence location
- Restored through acceptance of a found perpetuated location
- Considered a lost corner and reestablished through lost corner proportionate methods (include a plan view drawing showing distances and directions to other Public Land Survey Corners used for proportioning and determining the corner location)
- Restored or reestablished in a location that differs from a previous restoration or reestablishment (include a plan view drawing and indicate what was set and /or found)

Describe the monument and accessories used to perpetuate the location of this corner. (Include a plan view drawing and indicate what was set and/or found)

Grant Co. Coords.  
 (N) 640710.69  
 (E) 883311.75  
 The W 1/4  
 corner of Section 14  
 T. 8 N., R. 1 W  
Grant County, Wisconsin  
 Job ID: 2002-G  
 Book # 598

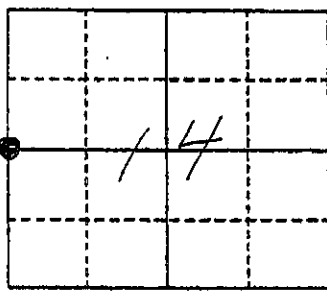
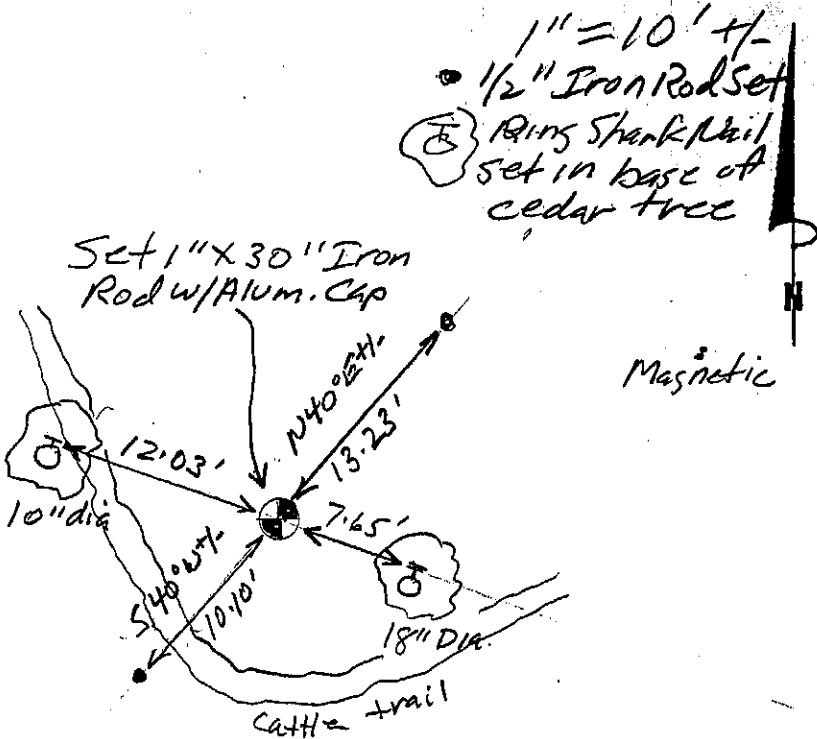

● = Location of Corner

Michael R. LaRosa  
 I, Michael R. LaRosa (Type or print name) certify that the corner location shown on this record was determined by me or under my direction and control and that this U.S. Public Land Survey Monument Record is correct and complete to the best of my knowledge and belief.

Michael R. LaRosa 7/8/2002  
 Signature Date



Index No. \_\_\_\_\_