

GRANT COUNTY

GOVERNMENT CORNER RECORD

S 1/4 CORNER, SECTION 9, TOWNSHIP 8 NORTH, RANGE 1 WEST
 TOWN, CITY OR VILLAGE OF MUSCODA

TYPE OF MONUMENT: 3/4" IRON ROD SET ELEVATION-M.S.L. DATUM _____

STATE PLANE COORDINATES: N _____

WISCONSIN SOUTH ZONE E _____

WITNESSES TO CORNER LOCATION

SEAN M. WALSH
PATRICK J. DEDERICH

SECTION 9, T 8 N, R 1 W
 TOWN OF MUSCODA

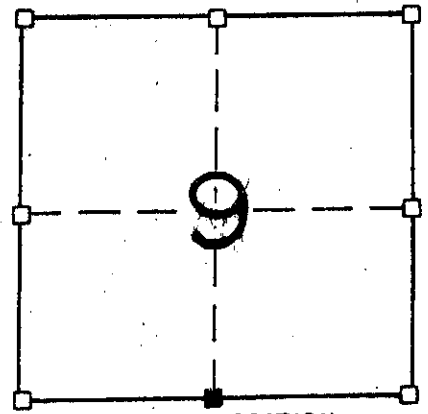

NORTH

TIE SKETCH
 (SHOW ALL HELPFUL FEATURES)

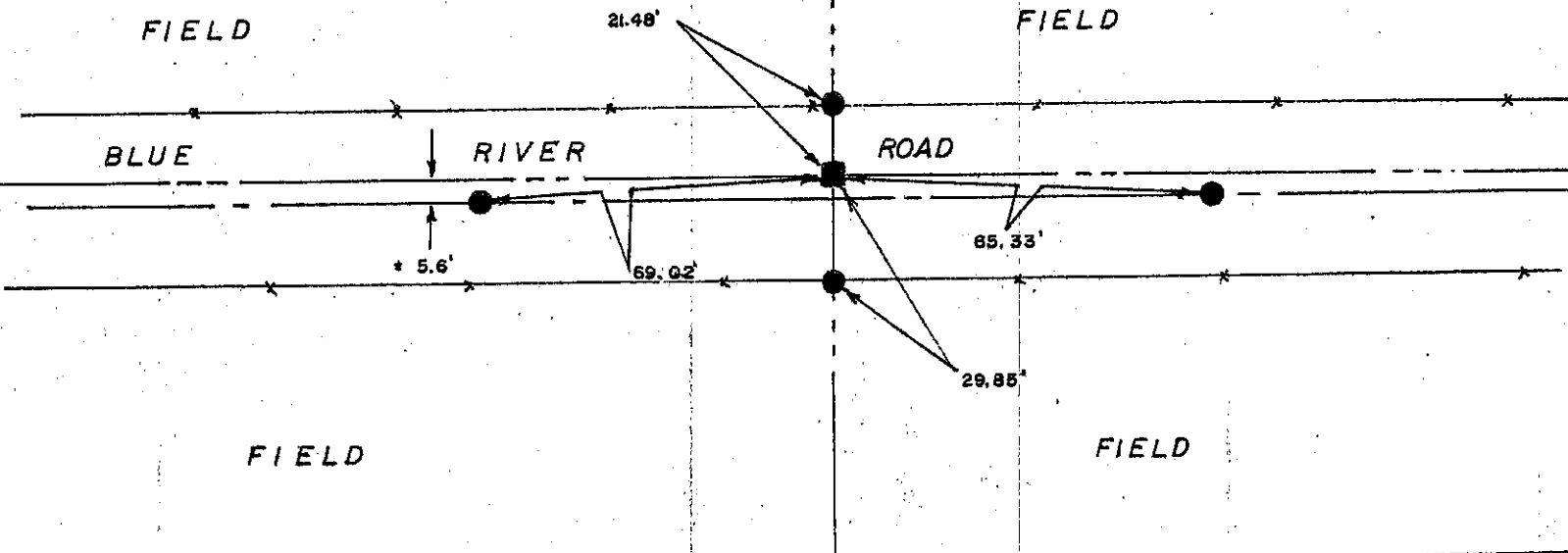

SURVEYOR'S CERTIFICATE
 STATE OF WISCONSIN)
 COUNTY) SS

SEAL S-1454

I, Matthew J. Janiak, DO HEREBY CERTIFY THAT the above corner
has been established under my direction according to
information shown hereon at a single proportioned position
on the South line of section 9 after searching public
records and finding no evidence of record or physical
evidence of its location, and that this information is
correct to the best of my information knowledge and belief

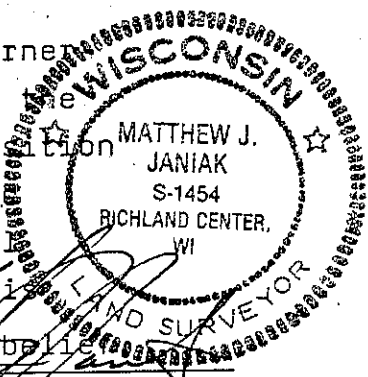

DATED THIS 22nd DAY OF SEPT, 1989

REGISTERED LAND SURVEYOR

CORNER CODE

(OVER)