

Stock No. 26273

Muscoda T.

SHEET 7 OF 13

RECORD OF CORNER MONUMENTATION

S1/4 CORNER, SECTION 6 TOWNSHIP 8 N., RANGE 1 West Grant COUNTY, WISCONSIN

N

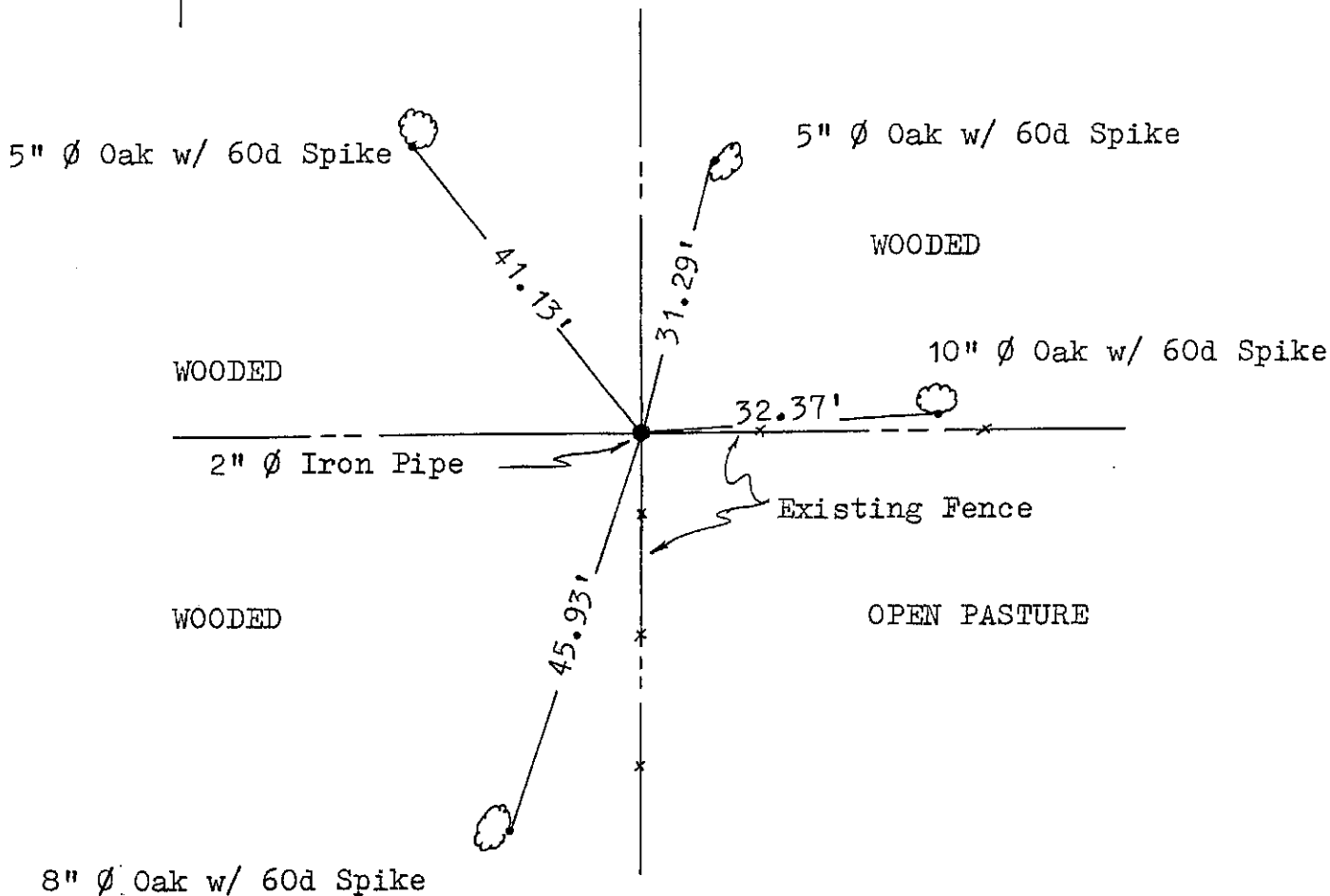
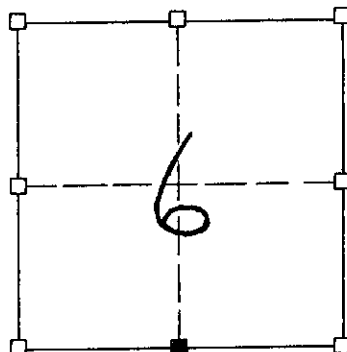

The records indicate this corner was established in 1833, no evidence of this corner exists, however, a 1" Ø iron pipe was found and accepted as the corner. An EDM/T2 traverse of the South Line of Section 6 compared very well with the original notes. I replaced said corner with a 2" Ø iron pipe and placed ties indicated above. I hereby certify that this corner and these ties are correct to the best of my knowledge and belief.

Paul W. Chafer
PAUL W. CHAFER S-1521
REGISTERED LAND SURVEYOR

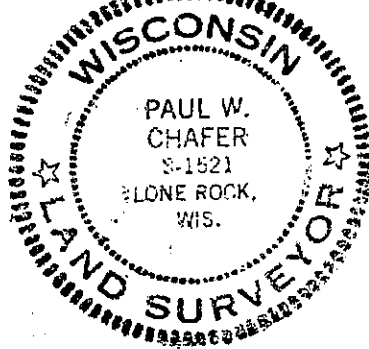

AUG 29 1986

p. 32