

REC'D JUN 4 1997

# GRANT COUNTY U.S. PUBLIC LAND SURVEY MONUMENT RECORD

South 1/4 corner 25, 7-3W

TYPE OF MONUMENT:

TIES ARE AS INDICATED ON SKETCH

WITNESSES TO CORNER LOCATION

Christopher G. Reedy

Christopher J. Ruetten

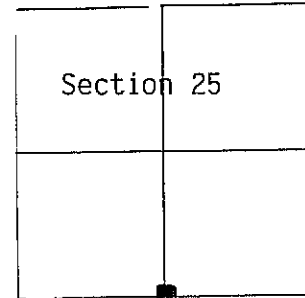

CORNER LOCATION

### BASIS FOR MONUMENT LOCATION

Due to lack of adequate record evidence for this corner and no existing monumentation for this corner, I have accepted the physical occupation as the only available acceptable evidence and monumented and perpetuated as shown hereon.

I, do hereby certify that this information is correct and true to the best of my knowledge and belief.

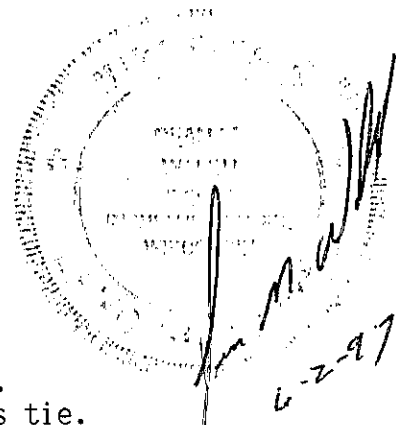

- indicates 3/4" x 24" iron rod placed at corner.
- indicates 3/4" x 24" iron rod placed at witness tie.

### TIE SKETCH

