

Survey Monument Record

CORNER NO. _____ FEB 5 1996
 SECTION 30
 TOWN 7N
 RANGE 3W

TYPE OF MONUMENT 1" Iron Pipe
 STATE PLANE COORDINATES: N _____
 E _____
 ELEVATION — M.S.L. DATUM: _____
 THETA ANGLE: _____
 FIELD BOOK: 95-11
 PAGE _____

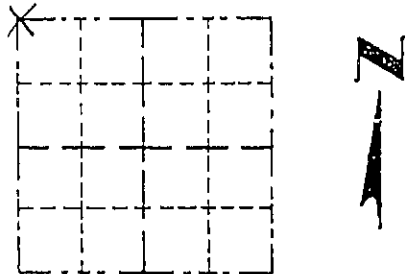

LOCATION
 (Indicated by "X")

- FOUND PERPETUATED LOCATION
- OBLITERATED EVIDENCE LOCATION
- LOST CORNER (RESTORED BY PROPORTIONATE METHODS)

BASIS FOR MONUMENT LOCATION

(Use reverse side if necessary)

Show info such as: History of corner, with reference to Vol. and pg., dates, surveyor; exact description of monument replaced; if location computed, by taped or EDM traverse; landowner, remarks, etc.

There are no survey records of this corner since the original government survey. Ownership records indicate that the corner has been maintained since the mid 1800's. The nearby corner for the west side of the town line has had no change of ownership across the line between section 25 and 24 since this time. The original bearing trees are gone. The occupied location of a fence East and South and a field fence to the northwest was accepted as the corner location and monuments EDM shots on the fence lines along the north line of the section do not vary off the line more than a few feet despite the rough terrain.

CERTIFIED CORRECT TO THE BEST OF MY KNOWLEDGE AND BELIEF

Michael R. LaRosa
 Registered Land Surveyor

DATE: 1/10/1996

TIE SKETCH

Show at least ~~two~~ (4) ties and monument

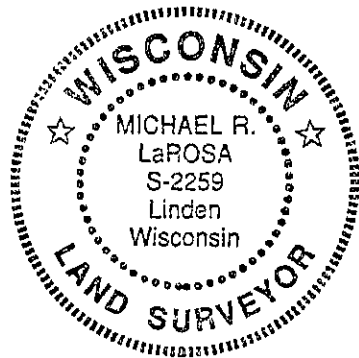

1" = 30' ±
 Legend
 x-x fence
 o 1/2" Iron Pipe St.

