

FEB 26 1996

GRANT COUNTY U.S. PUBLIC LAND SURVEY MONUMENT RECORD

TYPE OF MONUMENT: 3/4" X 24" Iron Rod
TIES ARE AS INDICATED ON SKETCH

WITNESSES TO CORNER LOCATION

Sean M. Walsh

Christopher G. Reedy

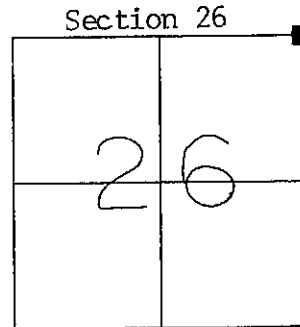
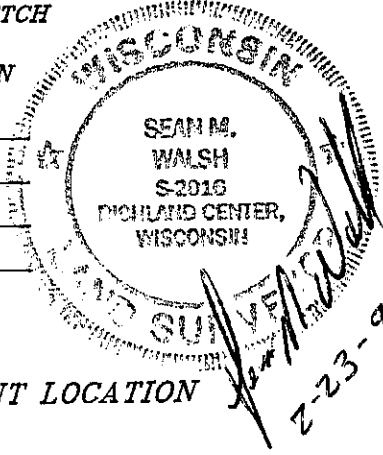

CORNER LOCATION
T7N, R3W
Town of Marion

BASIS FOR MONUMENT LOCATION

Subsequent to Original Gov't. Survey, this corner was used in 1893 by Mr. Charles Sampson at which time he verified the existence of the White Oak Tree shown below.

I accepted the white Oak tree shown below as the one used in the Original Gov't. Survey and the 1893 survey by Sampson. This location fits well with previously documented dimensions along the North and East lines of Section 26.

I monumented and perpetuated this corner in accordance with the information contained hereon.

I, do hereby certify that the information contained hereon is correct and true to the best of my information, knowledge and belief.

TIE SKETCH

● - 3/4" X 24" Iron Rod Set as Tie

Tree ties are 60d pole spikes set in blazes as indicated.

Distances measured horizontally by EDM.

