

OCT 26 1990

GRANT COUNTY GOVERNMENT CORNER RECORD

E 1/4 CORNER, SECTION 22, TOWNSHIP 7 NORTH, RANGE 3 EAST - WEST, TOWN, ~~WEST~~ OF MARION

TYPE OF MONUMENT: 3/4" X 24" IRON ROD ELEVATION - M.S.L. DATUM

STATE PLANE COORDINATES: N

WISCONSIN SOUTH ZONE E

WITNESSES TO CORNER LOCATION

SEAN M. WALSH

PATRICK J. DEDERICH

SECTION 22, T 7 N, R 3 EW TOWN OF MARION

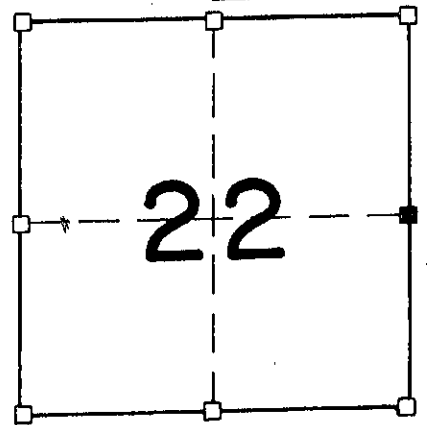

■ - CORNER LOCATION

● - 3/4" X 24" IRON ROD SET

NORTH

ABANDONED

TIE SKETCH (SHOW ALL HELPFUL FEATURES) FIELD

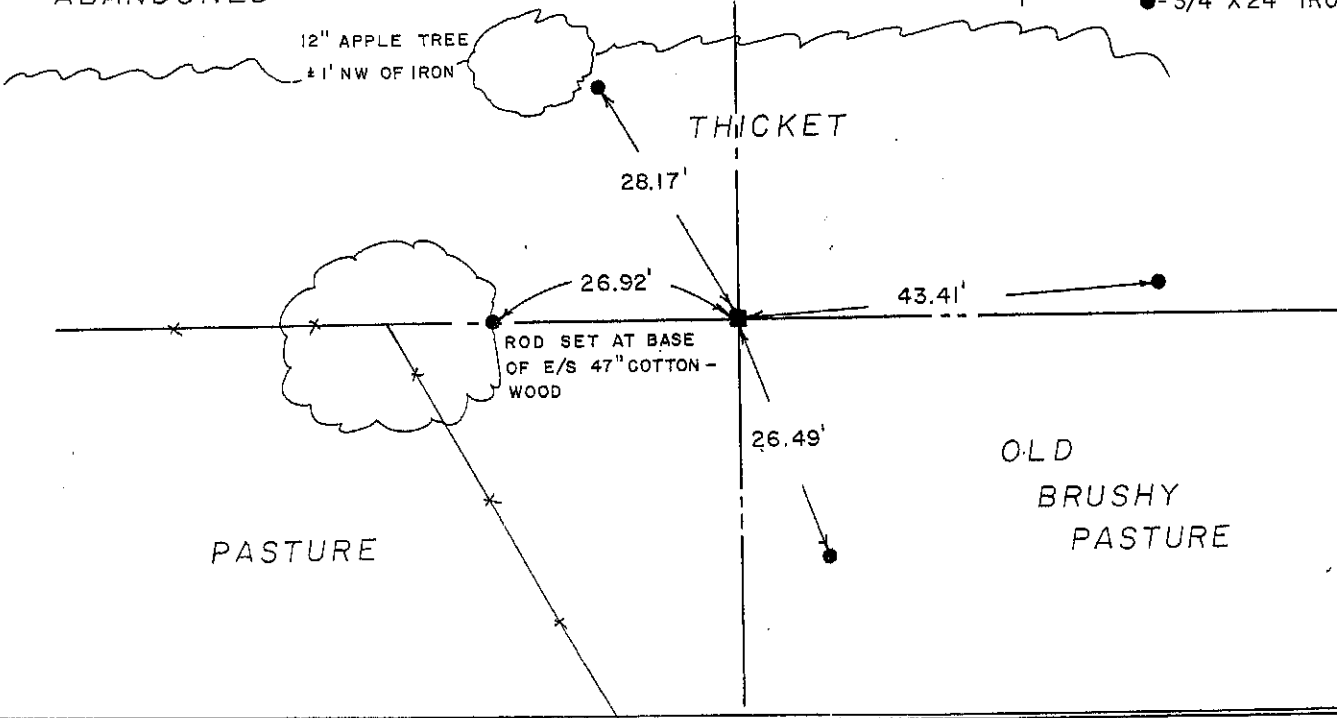

SURVEYOR'S CERTIFICATE
STATE OF WISCONSIN)
RICHLAND COUNTY) ss

SEAL S-1454

I, Matthew J. Janiak, DO HEREBY CERTIFY THAT the above corner has
been established under my direction and supervision in accordance
with the information contained hereon and that this information is
correct to the best of my knowledge, information and belief.
This location is at the extension of the occupied East/West
line and on a straight line between the Northeast and Southwest
corners.

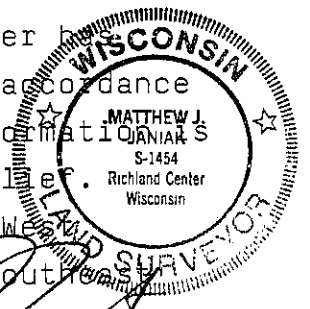

DATED THIS 3rd DAY OF October, 1990

Matthew J. Janiak
REGISTERED LAND SURVEYOR

p. 16