

U.S. PUBLIC LAND SURVEY MONUMENT RECORD TIE SHEET GRANT COUNTY, WISCONSIN

CORNER:
EAST 1/4 CORNER
SECTION 11, T 7 N, R 3 W
GRANT COUNTY, WISCONSIN

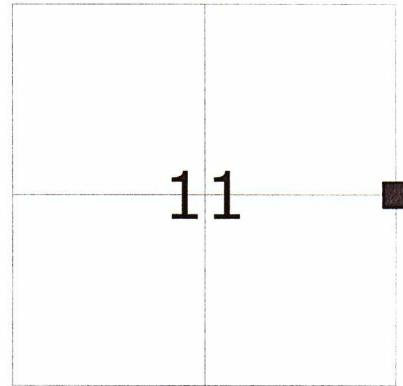

History of original corner establishment and subsequent restorations and descriptions of any record. Monument, occupation, testimonial or other evidence considered.

Monument was established using existing occupied E-W 1/4 line of Section 11 and the existing N-S occupied fence location for the E 1/4 corner of Section 11. Monument was set, and 4 new ties were set and its location was verified by Robotic Station and G.N.S.S. traverse of the area.

- LEGEND**
- = Section Corner Set 3/4" Rebar Weighing 1.502 Lbs./Lin. Ft.
 - = Set 3/4" Rebar Weighing 1.502 Lbs./Lin. Ft.
 - = Fence



NOT TO SCALE

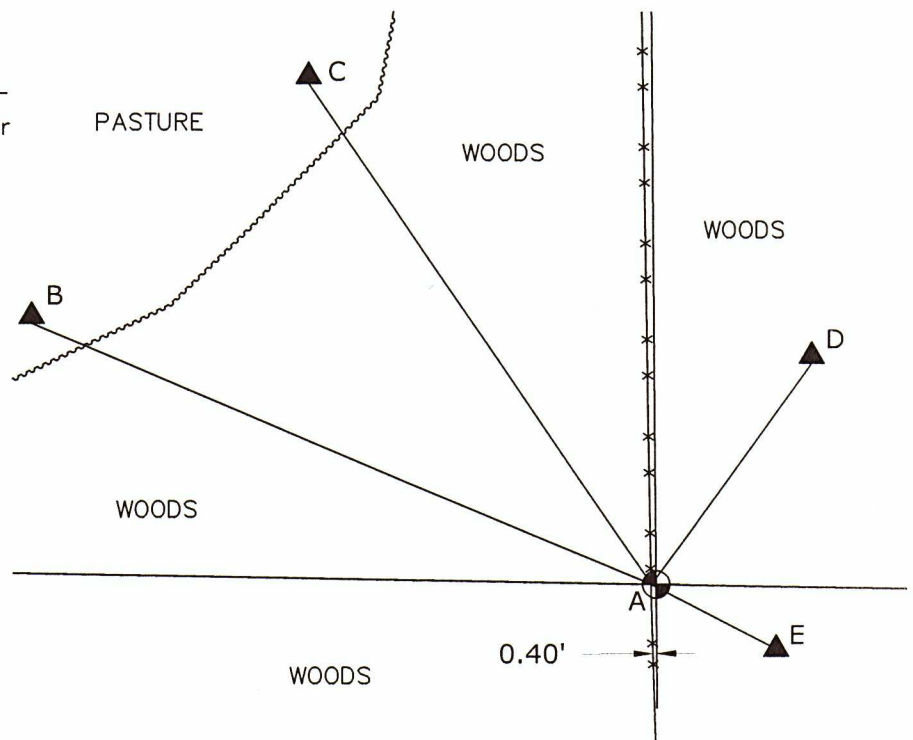

LINE	BEARING	DISTANCE
A-B	N66°44'07"W	70.43'
A-C	N34°10'52"W	63.85'
A-D	N34°28'57"E	28.74'
A-E	S61°32'24"E	14.20'

I, Keith E. Dalsing, Wisconsin Professional Land Surveyor, S-1989, certify that the corner location shown on this record was determined by me or under my direction and control and that this U.S. Public Land Survey Monument record is correct and complete to the best of my knowledge and belief.

Keith E. Dalsing, S-1989
Professional Land Surveyor

Date: 7-27-21