

Survey Monument Record

TYPE OF MONUMENT 3/4" X 24" IRON
BAR SET AT CORNER

CORNER NO. 107
 SECTION 28
 TOWN 7N
 RANGE 2W

FIELD BOOK: 97-34
 PAGE _____

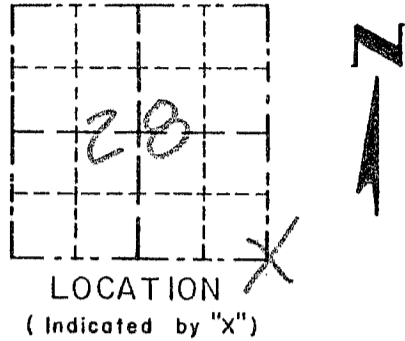

BASIS FOR MONUMENT LOCATION

(Use reverse side if necessary)

Show info such as: History of corner, with reference to Vol. and pg, dates, surveyor; exact description of monument replaced; if location computed, by taped or EDM traverse; landowner, remarks, etc.

SEAL:

CORNER SET IN 1832 BY HARVEY PARKE. NO RECORD OF CORNER FOUND SINCE ORIGINAL SURVEYS; CORNER WAS SET ONLINE WITH NORTH/SOUTH FENCE FOR EASTING, NORTHING WAS SET BY A PROJECTION OF AN EAST/WEST FENCE, WEST OF CORNER. VERIFIED ITS LOCATION USING EDM METHODS.

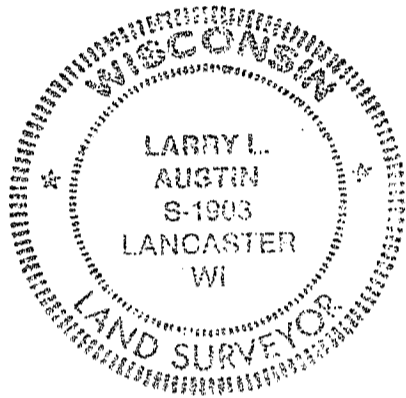

CERTIFIED CORRECT

Larry L. Austin
 Registered Land Surveyor
 DATE: 12/31/97

TIE SKETCH

Show at least three (3) ties and monument

LEGEND

- 3/4" X 24" IRON BAR SET 18" BELOW SURFACE
- 3/4" X 24" IRON BAR SET AT-GRADE
- X X EXISTING FENCE

