

MAR 28 1995

GOVERNMENT CORNER RECORD

Northwest CORNER, SECTION 13, TOWNSHIP 7 NORTH, RANGE 2 EAST - WEST,
TOWN, CITY OR VILLAGE OF Hickory Grove
TYPE OF MONUMENT: 3/4" x 24" Iron rod set ELEVATION - M.S.L. DATUM _____

WITNESSES TO CORNER LOCATION

Sean M. Walsh

Christopher G. Reedy

Curtis J. Cummer

SECTION 13, T. 7 N, R. 2 EW
TOWN OF Hickory Grove

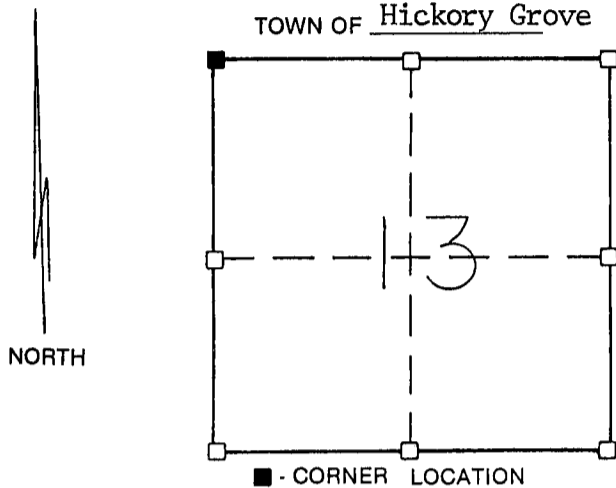

TIE SKETCH
(SHOW ALL HELPFUL FEATURES)

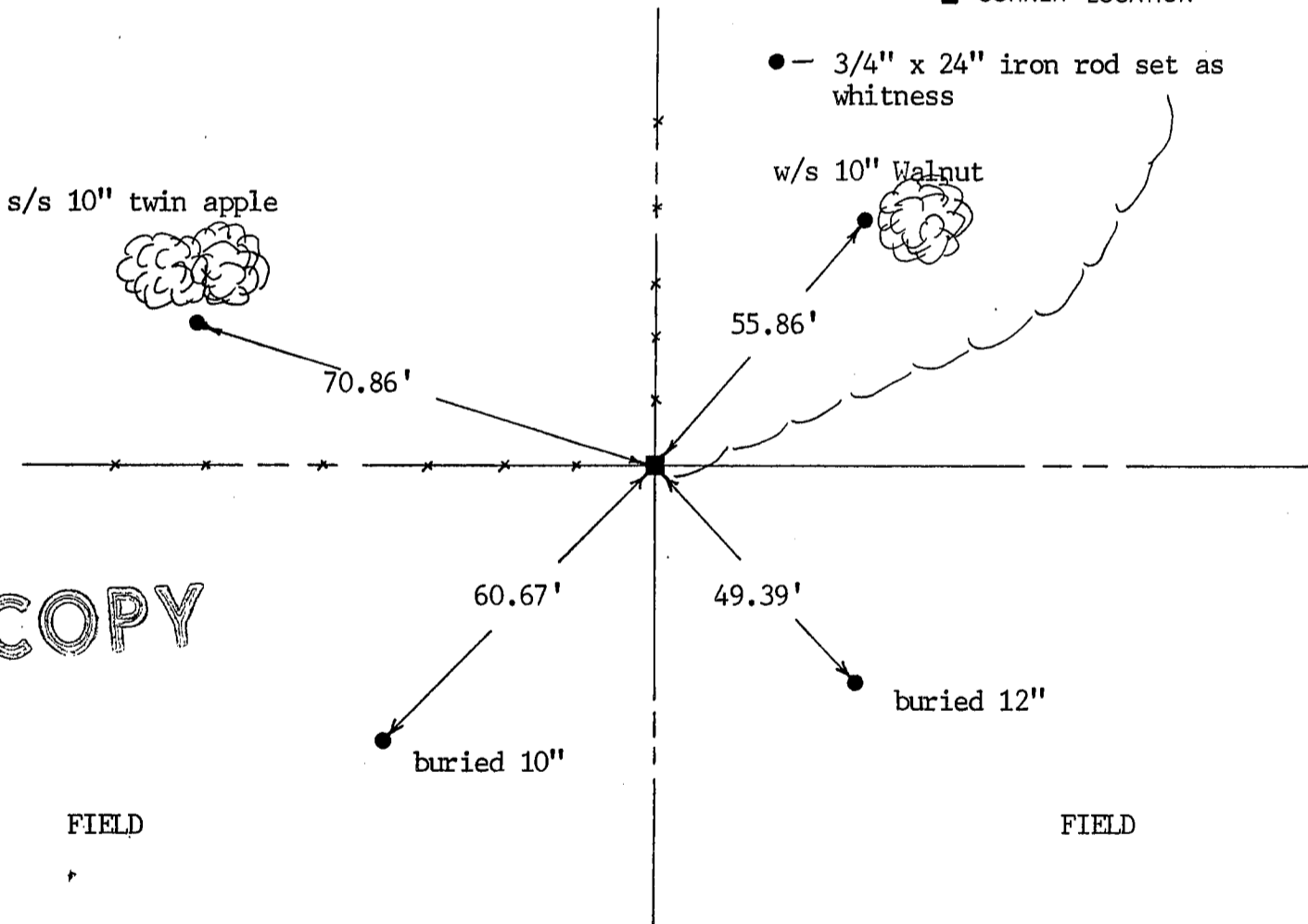

COPY

SURVEYOR'S CERTIFICATE

SEAL S. 2016

I, Sean M. Walsh, DO HEREBY CERTIFY THAT I have re-established this corner at this location of physical occupation as the best available evidence and that this information is correct and true to the best of my information, knowledge and belief.

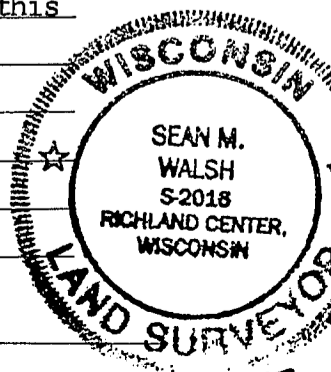

DATED THIS 15 DAY OF MARCH, 19 95

Sean M. Walsh
REGISTERED LAND SURVEYOR