

JAN 19 1996

GRANT COUNTY SURVEY MONUMENT RECORD

West One-quarter corner Section 7, T7N, R2W

TYPE OF MONUMENT: 3/4" X 24" IRON ROD PLACED

TIES ARE 3/4" X 24" IRON RODS SET AT BASE OF TREE AS NOTED ON SKETCH BELOW

SECTION 7, T7N, R2W

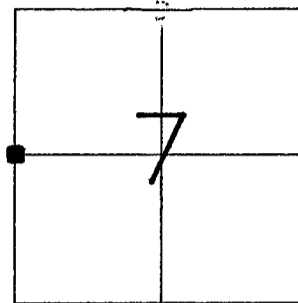

CORNER LOCATION

BASIS FOR MONUMENT LOCATION

I, SEAN M. WALSH, REGISTERED LAND SURVEYOR, DO HEREBY CERTIFY THAT I HAVE RE-ESTABLISHED THIS CORNER IN ACCORDANCE WITH THE INFORMATION CONTAINED HEREON AND THAT SUCH INFORMATION IS CORRECT AND TRUE TO THE BEST OF MY INFORMATION, KNOWLEDGE AND BELIEF.

AFTER AN EXTENSIVE SEARCH OF THE GRANT COUNTY SURVEY RECORDS, I WAS ABLE TO FIND ONLY ONE RECORD OF THIS CORNER HAVING BEEN USED SUBSEQUENT TO THE ORIGINAL GOV' T. SURVEY. MR. HERBERT J. GOULD USED THIS CORNER IN 1889 AND NOTED ONE TREE IN GOOD CONDITION. NO EVIDENCE OF ANY PREVIOUS SURVEY EXISTS AT THIS TIME, THUS I RE-ESTABLISHED THIS CORNER AT A LOCATION WHICH IS HALF WAY ALONG THE EXISTING OCCUPIED WEST LINE OF SECTION 7. THE EXISTING OCCUPIED LINE PROVIDES THE ONLY ACCEPTABLE PHYSICAL EVIDENCE.

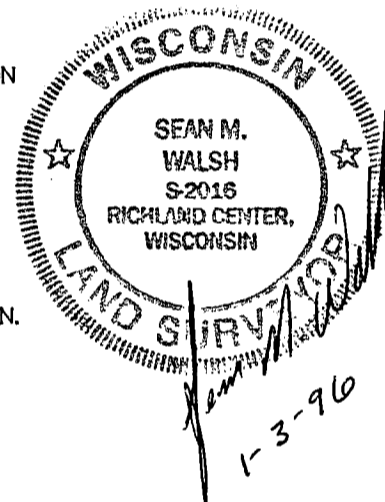

TIE SKETCH

NOT TO SCALE

