

JAN 19 1996

GRANT COUNTY

SURVEY MONUMENT RECORD

North One-quarter corner, Section 7, T7N, R2W
TYPE OF MONUMENT: 3/4" X 24" IRON ROD PLACED
TIES ARE AS INDICATED ON SKETCH

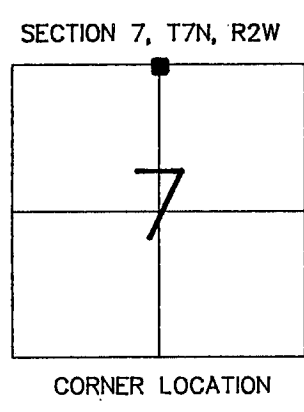

BASIS FOR MONUMENT LOCATION

I, SEAN M. WALSH, REGISTERED LAND SURVEYOR, DO HEREBY CERTIFY THAT I HAVE RE-ESTABLISHED THIS CORNER IN ACCORDANCE WITH THE INFORMATION CONTAINED HEREON AND THAT THIS INFORMATION IS CORRECT AND TRUE TO THE BEST OF MY INFORMATION, KNOWLEDGE AND BELIEF.

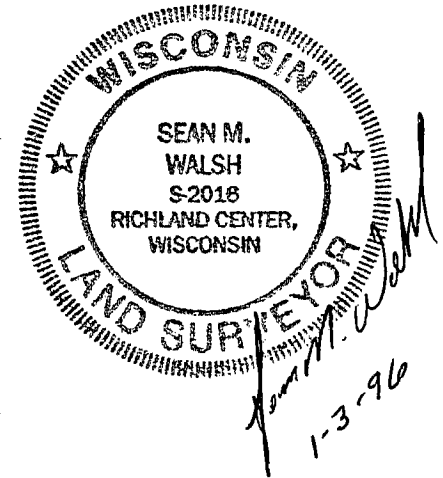

I HAVE RE-ESTABLISHED THIS CORNER AT THE LOCATION OF PHYSICAL OCCUPATION AS THE ONLY ACCEPTABLE EVIDENCE AVAILABLE. IN 1889 HERBERT J. GOULD LOCATED THIS CORNER AND PERPETUATED ITS LOCATION WITH TWO TREES, NO EVIDENCE OF WHICH REMAINS. THIS LOCATION FITS WELL WITH THE REMAINDER OF SECTION 7, THUS I HAVE MONUMENTED AND PERPETUATED AS SHOWN HEREON.

TIE SKETCH

NOT TO SCALE

