

Survey Monument Record

CORNER NO. 97  
 SECTION 28  
 TOWN 6N  
 RANGE 6W

TYPE OF MONUMENT GRANT COUNTY MONUMENT

STATE PLANE COORDINATES: N \_\_\_\_\_  
 E \_\_\_\_\_

ELEVATION — M.S.L. DATUM: \_\_\_\_\_

THETA ANGLE: \_\_\_\_\_

FIELD BOOK: 95-19

PAGE 5

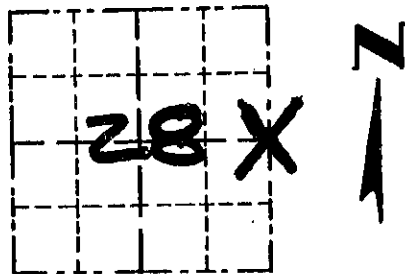

LOCATION  
 (Indicated by "X")

BASIS FOR MONUMENT LOCATION

(Use reverse side if necessary)

Show info such as: History of corner, with reference to Vol. and pg., dates, surveyor; exact description of monument replaced; if location computed, by taped or EDM traverse; landowner, remarks, etc.

SEAL:

GRANT COUNTY MONUMENT  
 PLACED AT OCCUPIED FENCE  
 NORTH-SOUTH AND REMNANTS  
 OF OLD FENCE WEST, AND  
 VERIFIED BY EDM TRAVERSE  
 OF THE AREA.

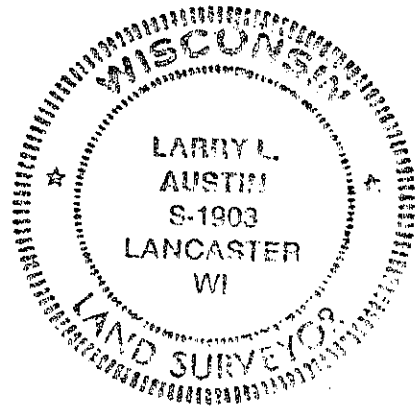

CERTIFIED CORRECT

*Larry L. Austin*  
 Registered Land Surveyor

DATE: 1/6/96

TIE SKETCH

Show at least three (3) ties and monument

