

Survey Monument Record

CORNER NO. 96
SECTION 28
TOWN 6N
RANGE 6W

TYPE OF MONUMENT GRANT COUNTY MONUMENT

STATE PLANE COORDINATES: N _____
E _____

ELEVATION — M.S.L. DATUM: _____

THETA ANGLE: _____

FIELD BOOK: 95-19

PAGE 5

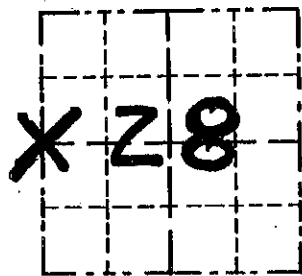

LOCATION
(Indicated by "X")

BASIS FOR MONUMENT LOCATION

(Use reverse side if necessary)

Show info such as: History of corner, with reference to Vol. and pg., dates, surveyor; exact description of monument replaced; if location computed, by taped or EDM traverse; landowner, remarks, etc.

SEAL:

GRANT COUNTY MONUMENT
WAS PLACED IN THE CENTER
LINE OF GASNER HOLLOW ROAD
NORTH-SOUTH AND FENCE
EAST-WEST, AND VERIFIED
BY EDM TRAVERSE OF THE
AREA.

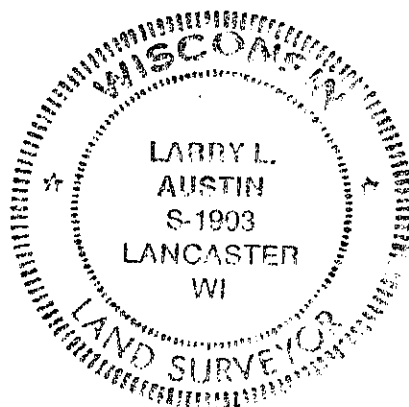

CERTIFIED CORRECT

Larry L. Austin
Registered Land Surveyor

DATE: 1/6/96

TIE SKETCH

Show at least three (3) ties and monument

