

CERTIFIED LAND CORNER

STATE OF WISCONSIN )  
 COUNTY OF GRANT ) S.S.

CERTIFICATE

I, Ronald R. Hayden, do hereby certify that on the 8th day of December 1987, I found (evidence) ~~(no evidence)~~ of the S 1/4 corner of Section 27, T 6 N, R 5 W, Fourth Principal Meridian, and I re-established said corner according to the Wisconsin Statutes as shown and described hereon.

Dated this 21 day of December 1987

Ronald R. Hayden

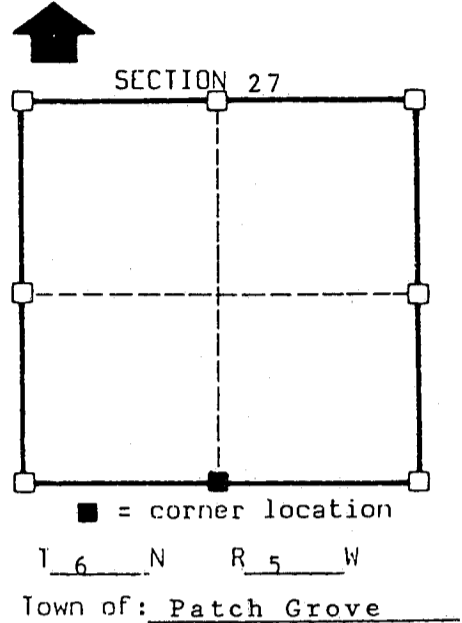

History of original corner establishment:

Town lines were established by Lucious Lyon.  
 Subdivision by Harvey Parke in 1833.

Description of corner evidence found:

See back.

Description of corner and witness monuments, references and accessories used to perpetuate the original or re-established location of this corner:

Witnesses to corner location:

Ronald R. Hayden  
Carol S. Hayden  
 \_\_\_\_\_  
 \_\_\_\_\_

See back for witness descriptions.

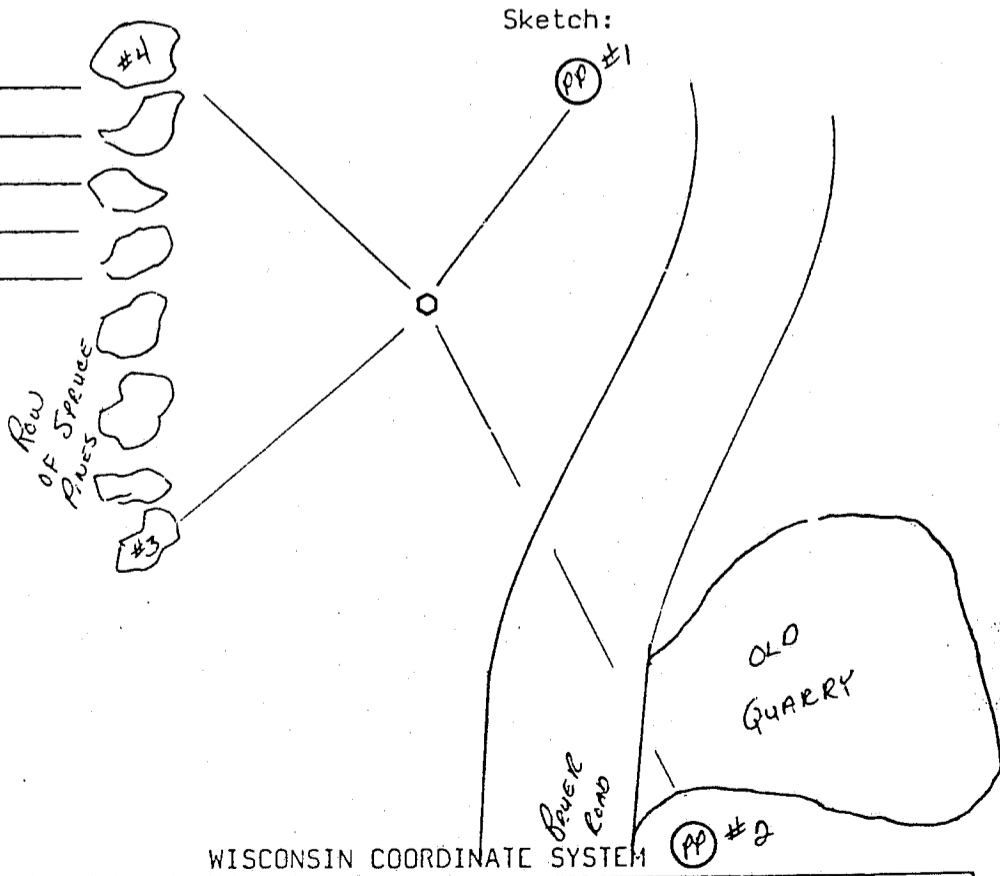

SURVEY CONTROL ORDER	
horizontal	
vertical	

WISCONSIN COORDINATE SYSTEM

Corner	East (X)	North (Y)	Elevation (Z)	Zone
Control Sta. Name				

#### CORNER EVIDENCE FOUND

I found no physical evidence of a corner, but I did find occupational evidence and after running an extensive control traverse and finding existing corner evidence in Sections 25, 26, 27, 34, 35, and 36, I determined the corner location. I found evidence of a down fence line at the corner location. Set was a 7/8" X 30" round iron bar flush with the surface of the ground and a metal fence post was set east of the corner and stones were placed around the iron bar. After an extensive search in the Grant County Court House, I found no resurvey evidence.

#### WITNESS DESCRIPTIONS

- 1) PK Nail set in the west side of a power pole which bears:  
N 40° E 42.77'.
- 2) PK Nail set in the west side of a power pole which bears:  
S 04° 40' 59" E 292.14'.
- 3) PK Nail set in the east root of a black spruce pine tree which bears: N 86° 48' 30" W 189.60'.
- 4) PK Nail set in the east root of a black spruce pine tree which bears: N 61° 43' 28" W 209.40'.