

CERTIFIED LAND CORNER

STATE OF WISCONSIN ) S.S.  
 COUNTY OF GRANT )

CERTIFICATE

I, Ronald R. Hayden, do hereby certify that on the 8th day of December 1987, I found (evidence) (~~no evidence~~) of the S 1/4 corner of Section 25, T 6 N, R 5 W, Fourth Principal Meridian, and I re-established said corner according to the Wisconsin Statutes as shown and described hereon.

Dated this 21 day of December 1987

*Ronald R. Hayden*

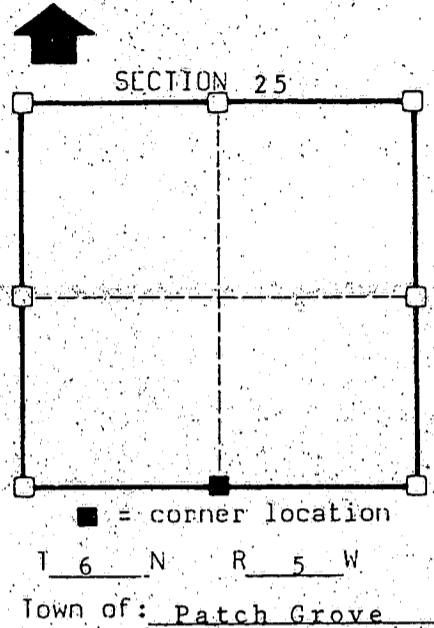
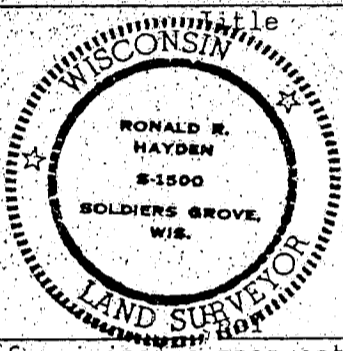

History of original corner establishment:

Town lines were established by Lucious Lyon. Subdivision by Harvey Parke in 1833.

Description of corner evidence found:

See back.

Description of corner and witness monuments, references and accessories used to perpetuate the original or re-established location of this corner:

Witnesses to corner location:

Ronald R. Hayden  
Carol S. Hayden

See back for witness descriptions.

Sketch:

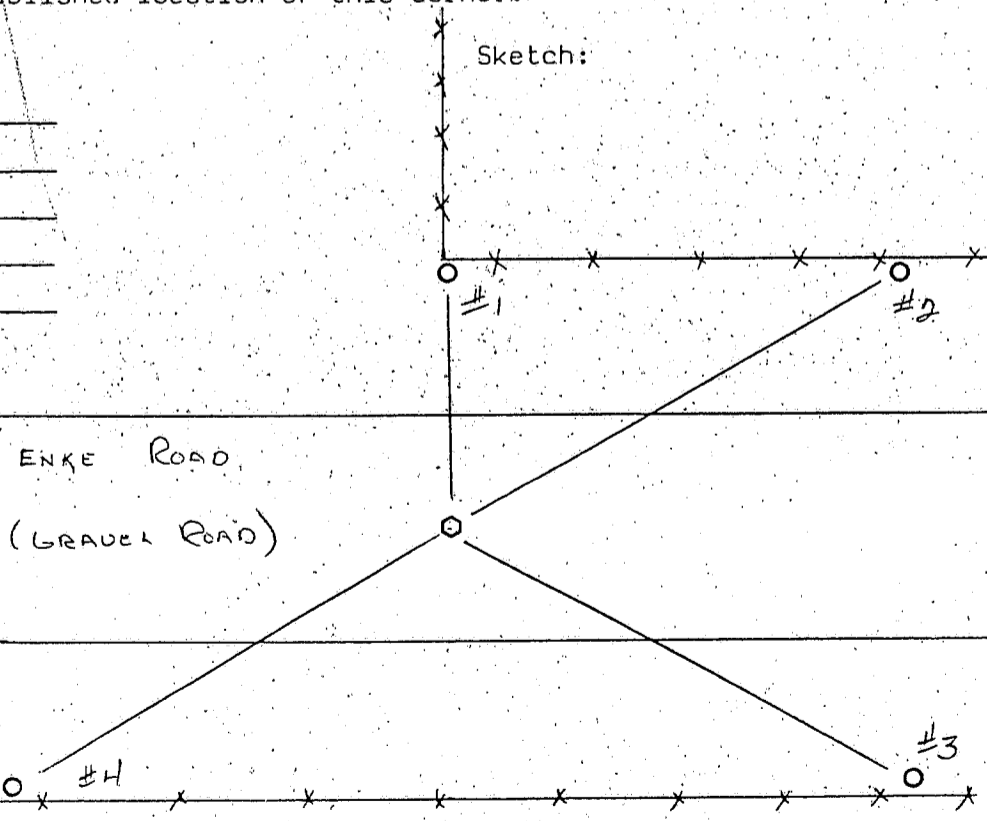

WISCONSIN SURVEY CONTROL ORDER
Horizontal
Vertical

WISCONSIN COORDINATE SYSTEM

Corner	East (X)	North (Y)	Elevation (Z)	Zone
Control Sta. Name				

#### CORNER EVIDENCE FOUND

I found no physical evidence of a corner, but I did find occupational evidence and after running an extensive control traverse and finding existing corner evidence in Sections 25, 26, 27, 34, 35, and 36, I determined the corner location. No evidence could be found at the Grant County Court House of any resurveys. Set was a 3/4" X 30" round iron bar set 8 inches below the surface of the gravel road.

#### WITNESS DESCRIPTIONS

- 1) Set a 3/4" X 30" round iron bar for the witness which bears:  
N 14° E 29.15'.
- 2) Set a 3/4" X 30" round iron bar for the witness which bears:  
N 52° E 49.64'.
- 3) Set a 3/4" X 30" round iron bar for the witness which bears:  
S 50° E 42.47'.
- 4) Set a 3/4" X 30" round iron bar for the witness which bears:  
S 55° W 52.63'.