

CERTIFIED LAND CORNER

STATE OF WISCONSIN)
 COUNTY OF GRANT) S.S.

CERTIFICATE

I, Ronald R. Hayden, do hereby certify that on the 8th day of December 1987, I found (evidence) ~~(no evidence)~~ of the SE corner of Section 25, T 6 N, R 5 W, Fourth Principal Meridian, and I re-established said corner according to the Wisconsin Statutes as shown and described hereon.

Dated this 21 day of December 1987

Ronald R. Hayden

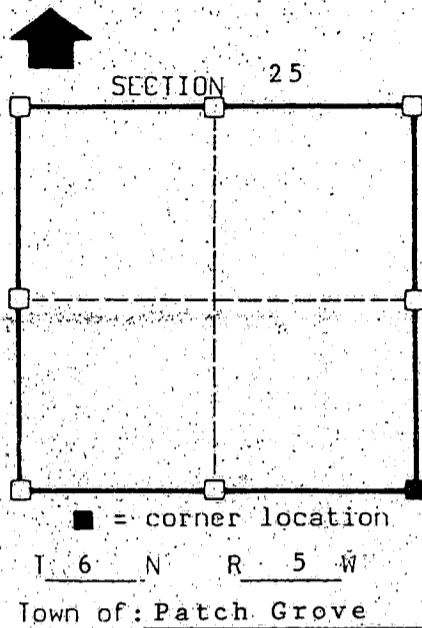
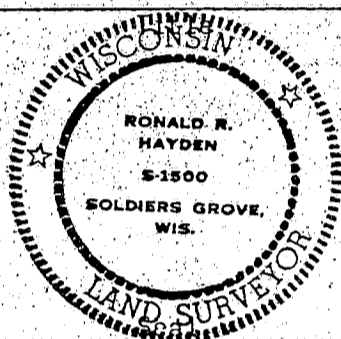

History of original corner establishment:

Town lines were established by Lucious Lyon.
 Subdivision by Harvey Parke in 1833.

Description of corner evidence found:

See back.

Description of corner and witness monuments, references and accessories used to perpetuate the original or re-established location of this corner:

Witnesses to corner location:

Ronald R. Hayden
Carol S. Hayden

ENKE ROAD
 (GRAVEL ROAD)

See back for witness description.

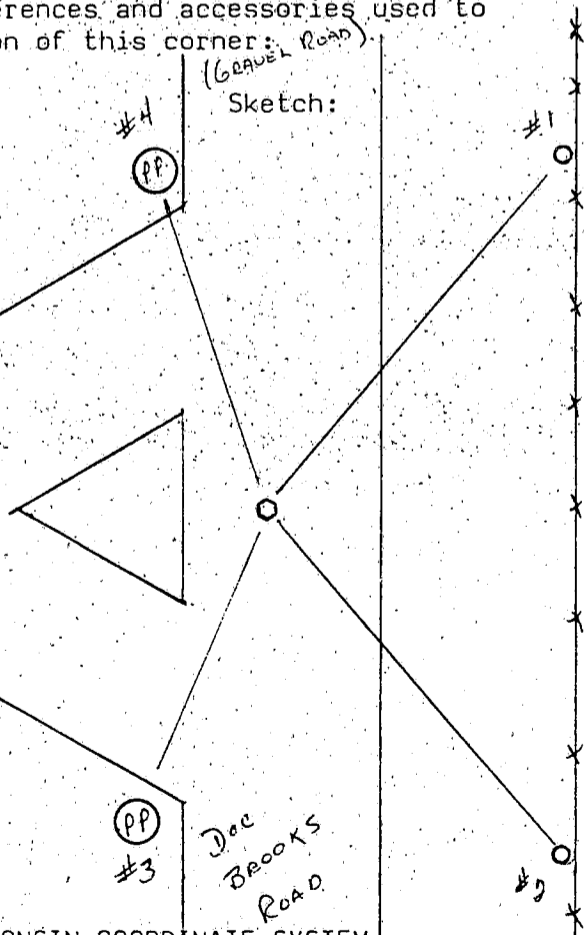

WISCONSIN COORDINATE SYSTEM

horizontal

vertical

Corner	East (X)	North (Y)	Elevation (Z)	Zone
Control Sta. Name				

CORNER EVIDENCE FOUND

I found the rusted remains of an iron bar which 3/8" remained. It was buried more than 1 foot below the surface of a gravel road known as "Doc Brooks Road". No other evidence was found and the bar was almost completely deteriorated. After a thorough investigation at the Grant County Court House I found no evidence of a bar being set nor any resurvey information. I accepted the remains as the corner and set a 7/8" X 30" round iron bar at the corner location. Bar is set 8 inches below the surface of the gravel road.

WITNESS DESCRIPTIONS

- 1) Set a 7/8" X 24" round iron bar for the witness which bears:
N 25° E 54.28'.
- 2) Set a 7/8" X 24" round iron bar for the witness which bears:
S 25° E 69.92'.
- 3) Set a PK Nail in the east side of a power pole which bears:
S 28° W 58.72'.
- 4) Set a PK Nail in the east side of a power pole which bears:
N 20° W 82.33'.

CERTIFIED LAND CORNER

STATE OF WISCONSIN)
 COUNTY OF GRANT) S.S.

CERTIFICATE

I, Ronald R. Hayden, do hereby certify that on the 8th day of December 1987, I found (evidence) ~~(no evidence)~~ of the SE corner of Section 25, T 6 N, R 5 W, Fourth Principal Meridian, and I re-established said corner according to the Wisconsin Statutes as shown and described hereon.

Dated this 21 day of December 1987

Ronald R. Hayden

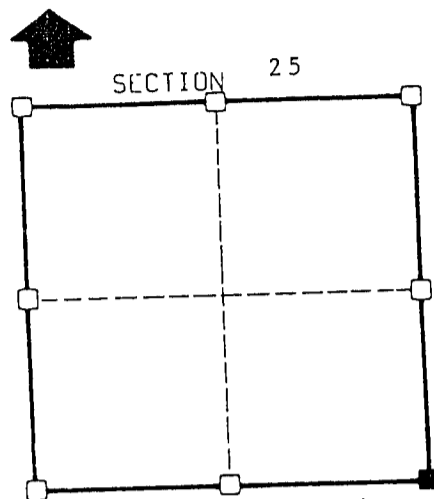
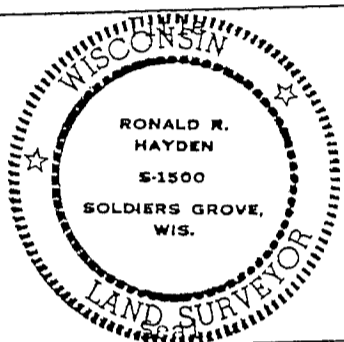

■ = corner location
 T 6 N R 5 W
 Town of: Patch Grove

History of original corner establishment:

Town lines were established by Lucious Lyon.
 Subdivision by Harvey Parke in 1833.

Description of corner evidence found:

See back.

Description of corner and witness monuments, references and accessories used to perpetuate the original or re-established location of this corner:

Witnesses to corner location:

Ronald R. Hayden
Carol S. Hayden

ENKE ROAD
 (GRAVEL ROAD)

See back for witness description.

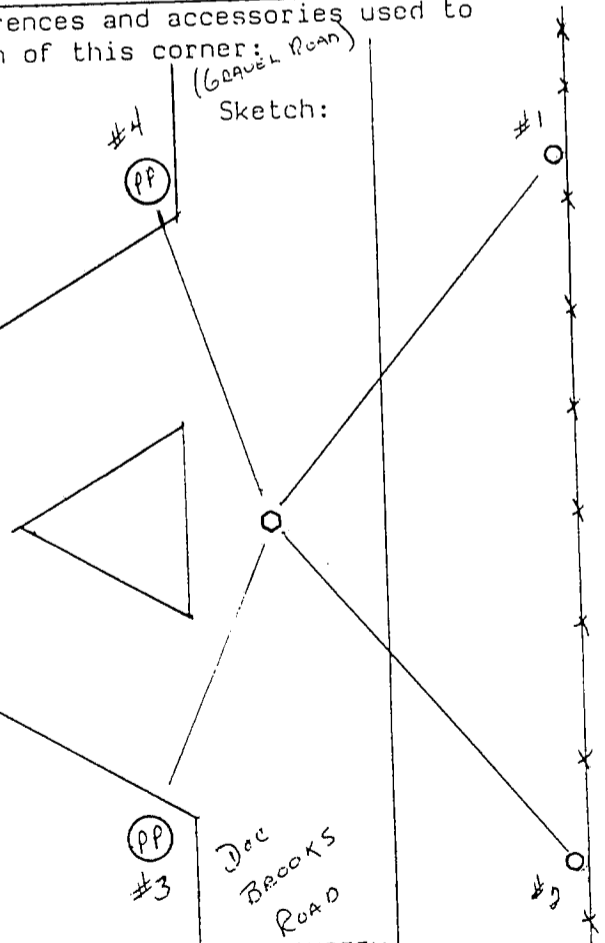

WISCONSIN COORDINATE SYSTEM

Corner	East(X)	North(Y)	Elevation(Z)	Zone
Control Sta. Name				

CORNER EVIDENCE FOUND

I found the rusted remains of an iron bar which 3/8" remained. It was buried more than 1 foot below the surface of a gravel road known as "Doc Brooks Road". No other evidence was found and the bar was almost completely deteriorated. After a thorough investigation at the Grant County Court House I found no evidence of a bar being set nor any resurvey information. I accepted the remains as the corner and set a 7/8" X 30" round iron bar at the corner location. Bar is set 8 inches below the surface of the gravel road.

WITNESS DESCRIPTIONS

- 1) Set a 7/8" X 24" round iron bar for the witness which bears:
N 25° E 54.28'.
- 2) Set a 7/8" X 24" round iron bar for the witness which bears:
S 25° E 69.92'.
- 3) Set a PK Nail in the east side of a power pole which bears:
S 28° W 58.72'.
- 4) Set a PK Nail in the east side of a power pole which bears:
N 20° W 82.33'.