

# GRANT COUNTY

## Survey Monument Record

GRANT COUNTY  
 TYPE OF MONUMENT Alum. Mon. SET  
 STATE PLANE COORDINATES: N \_\_\_\_\_  
 E \_\_\_\_\_  
 ELEVATION — M.S.L. DATUM: \_\_\_\_\_  
 THETA ANGLE: \_\_\_\_\_  
 FIELD BOOK: 95-03  
 PAGE 19

CORNER NO. 129  
 SECTION 33  
 TOWN 6N  
 RANGE 4W

### BASIS FOR MONUMENT LOCATION

(Use reverse side if necessary)

Show info such as: History of corner, with reference to Vol. and pg., dates, surveyor; exact description of monument replaced; if location computed, by taped or EDM traverse; landowner, remarks, etc.

ORIGINAL CORNER SET  
 IN 1832 BY SIBLEY.

CORNER WAS RESET  
 AT THE RECORDED DISTANCE  
 WEST OF THE NORTHWEST  
 CORNER, SECTION 4, T5N, R4W,  
 AND VERIFIED BY EDM  
 TRAVERSE OF THE AREA.

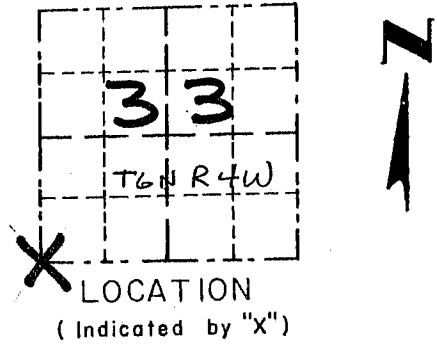

SEAL:

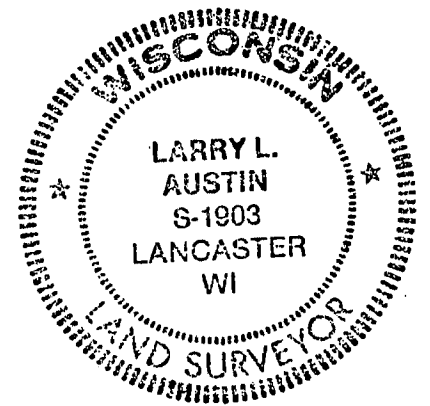

CERTIFIED CORRECT

*Larry L. Austin*  
 Registered Land Surveyor  
 DATE: 7/15/95

### TIE SKETCH

Show at least three (3) ties and monument

