

REC'D AUG 26 1998

Survey Monument Record

CORNER NO. _____
SECTION 9
TOWN 6N
RANGE 4W

TYPE OF MONUMENT ANGLE IRON POST IN CONCRETE
STATE PLANE COORDINATES: N _____
E _____
ELEVATION — M.S.L. DATUM: _____
THETA ANGLE: _____
FIELD BOOK: _____
PAGE _____

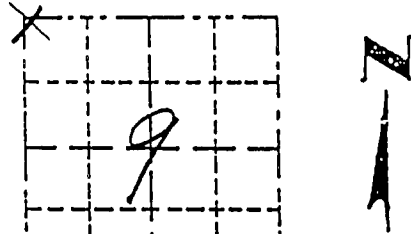

BASIS FOR MONUMENT LOCATION

(Use reverse side if necessary)

Show info such as: History of corner, with reference to Vol. and pg., dates, surveyor; exact description of monument replaced; if location computed, by taped or EDM traverse; landowner, remarks, etc.

LOCATION
(Indicated by "X")

- FOUND PERPETUATED LOCATION
- OBLITERATED EVIDENCE LOCATION
- LOST CORNER (RESTORED BY PROPORTIONATE METHOD)

An angle iron cornerpost in concrete noted in a survey by Lawrence Schmit dated 10/25/78 & revised 1/16/1980 was found in place. Ties were set as shown.



CERTIFIED CORRECT TO THE BEST OF MY KNOWLEDGE AND BELIEF

Michael R. LaRosa
Registered Land Surveyor
DATE: 6/26/1998

TIE SKETCH

Show at least (4) ties and monument

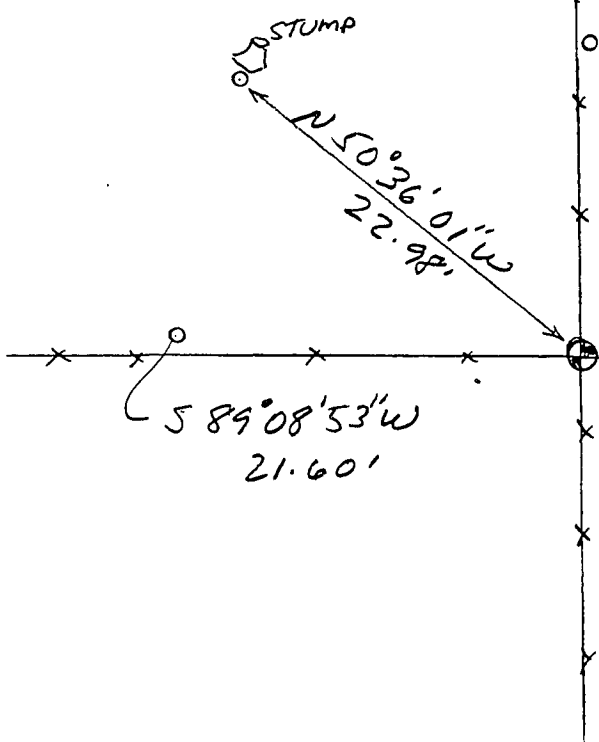

Legend
— x — fence
o 1/2" Iron Pipe Set
1" = 10' +/-