

JUN

GOVERNMENT CORNER RECORD

E 1/4 CORNER, SECTION 29, TOWNSHIP 6 NORTH, RANGE 3 ~~EAST~~ - WEST,
 TOWN, CITY OR VILLAGE OF Mt. Ida
 TYPE OF MONUMENT: 3/4" x 24" Iron Rod Placed ELEVATION - M.S.L. DATUM

WITNESSES TO CORNER LOCATION

SECTION 29, T. 6 N, R. 3 -EW
 TOWN OF Mt. Ida

Sean M. Walsh
 Scott H. Chyko

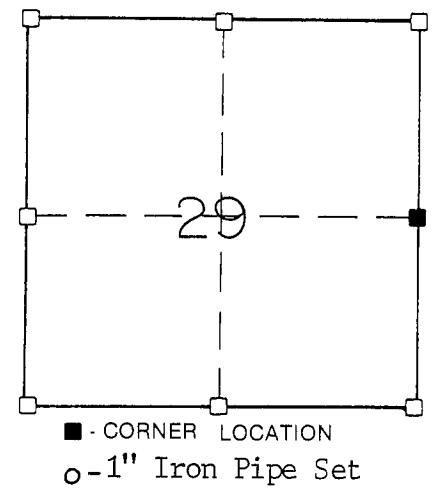

TIE SKETCH
 (SHOW ALL HELPFUL FEATURES)

PASTURE

PASTURE

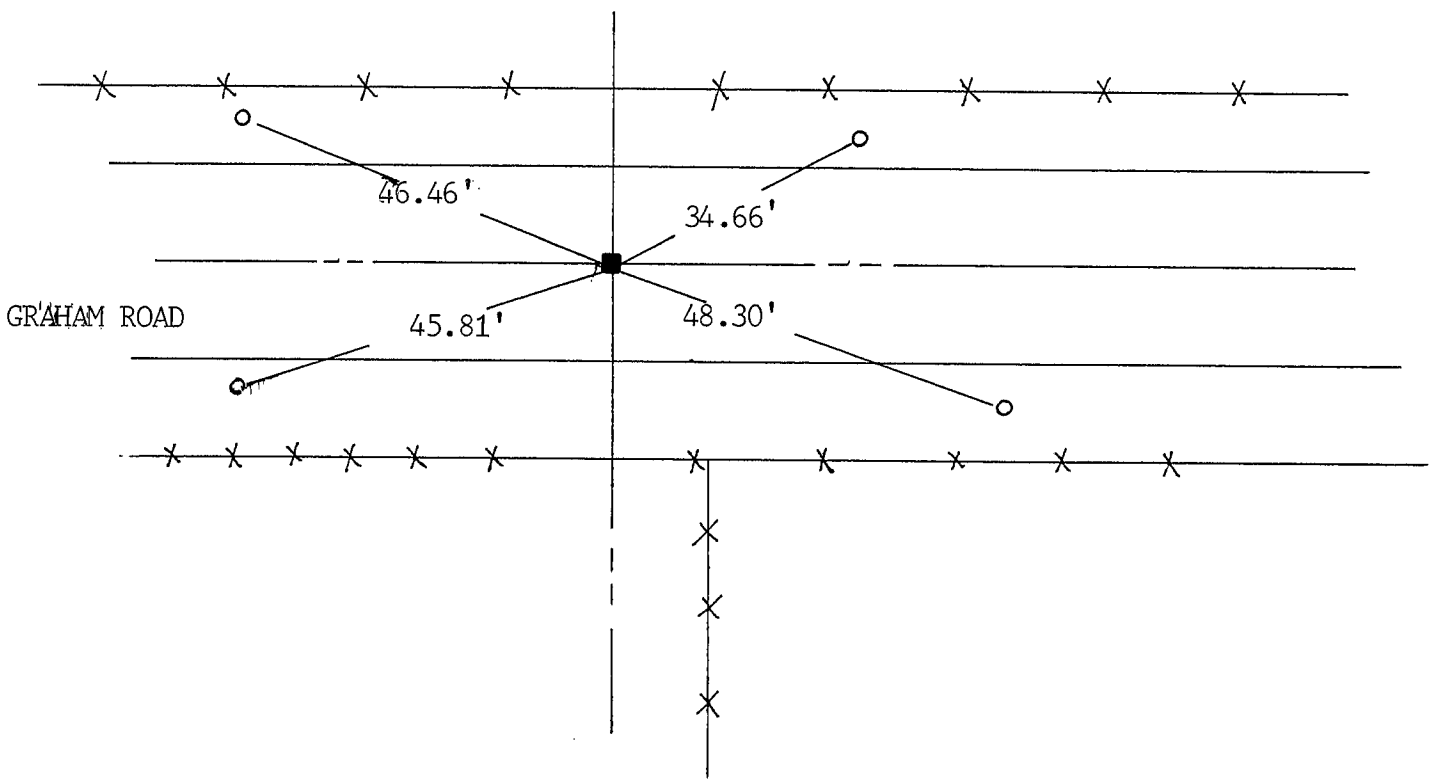

SURVEYOR'S CERTIFICATE

SEAL S-2016

Sean M. Walsh DO HEREBY CERTIFY THAT that I have accepted this corner at this location as I found a badly deteriorated iron pipe at this location. I accepted it as the best available evidence and monumented with a 3/4" x 24" Iron rod and perpetuated as shown hereon.

This information is correct and true to the best of my knowledge, information and belief.

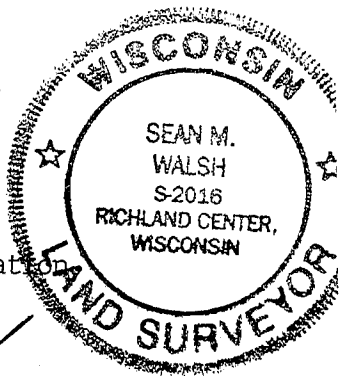

DATED THIS 23 DAY OF MAY, 19 94

Sean M. Walsh
 REGISTERED LAND SURVEYOR