

# GRANT COUNTY

## Survey Monument Record

TYPE OF MONUMENT 7/8" x 24" iron rod

STATE PLANE COORDINATES: N \_\_\_\_\_  
E \_\_\_\_\_

ELEVATION — M.S.L. DATUM: \_\_\_\_\_

THETA ANGLE: \_\_\_\_\_

FIELD BOOK: \_\_\_\_\_

PAGE \_\_\_\_\_

CORNER NO. 52

SECTION 7

TOWN 6 N

RANGE 2 W

### BASIS FOR MONUMENT LOCATION

(Use reverse side if necessary)

Show info such as: History of corner, with reference to Vol. and pg., dates, surveyor; exact description of monument replaced; if location computed, by taped or EDM traverse; landowner, remarks, etc.

Corner set from ties to State Trunk Highway "61" plans dated 1951.

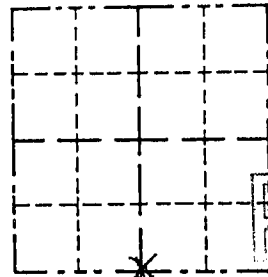

LOCATION

(Indicated by "X")

SEAL:

JAN 1 1983

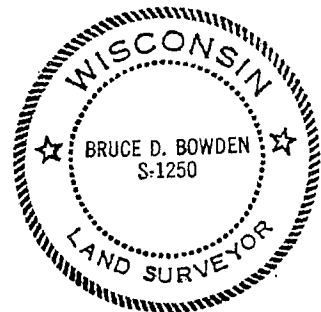

### LEGEND

- 7/8" x 24" round, solid, iron rod set
- △ Right - of - way post
- \*—\*—\* Fence
- 1" square x 24" solid steel rod

REVISED 12-15-93 BDB  
CERTIFIED CORRECT

*Bruce D. Bowden*  
Registered Land Surveyor

DATE: August 3, 1983

### TIE SKETCH

Show at least three (3) ties and monument

