

55050

# U.S. PUBLIC LAND SURVEY MONUMENT RECORD - GRANT COUNTY, WI

Section 17, Town 5 North Range 5 West, Town of Patch Grove (a)

NOTE: This form is intended and designed to fulfill all requirements of the Wisconsin Administrative Code Chapter A-E 7.08, U.S. Public Land Survey Monument Record (3) (a) (b) (c) (d) (e) (f) (g) (h) (i).

**CERTIFICATE:** (i)

I, Aaron J. Austin, Wisconsin Professional Land Surveyor, do hereby certify that the corner location on this record was determined by me and/or under my direct supervision and that this U.S. Public Land Survey Monument Record is correct and complete to the best of my knowledge and belief.

Dated this 4th day of December, 2019.

*Aaron J Austin*  
Aaron J. Austin, S-2922

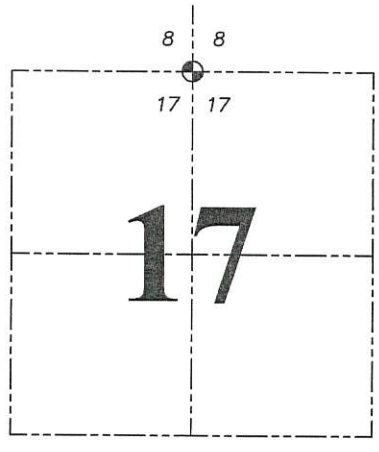
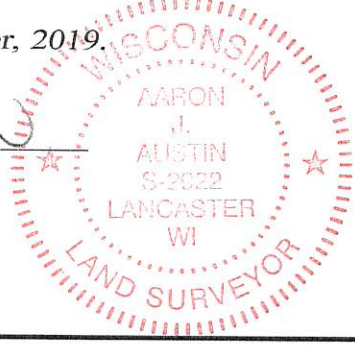

⊕ = CORNER LOCATION

Grant County Coordinates:  
NAD 83 (2011)  
Northing: 548,676.46  
Easting: 743,666.68

HISTORY OF CORNER ESTABLISHMENT:

Original corner was set in 1832 by Robert Clark.  
John Clark tied to the corner on a Survey dated 9-21-1854 and filed in Book C, Page 119.  
David Davis accepted an iron post in concrete on a Survey dated 11-24-1980 filed in Book H, Page 39.

DESCRIPTION OF CORNER EVIDENCE FOUND: (b) (f) (g) (h)

I found no evidence the monument or the bearing trees from the original Government Survey.  
I found a Angle Iron post in concrete as established by David Davis and accepted this location after I verified the post with G.P.S. and E.D.M. methods.

DESCRIPTION OF CORNER AND WITNESS MONUMENTS: references and accessories used to perpetuate the original or re-established location of this corner. (c) (d) (e)

Witnesses to corner location Shane Austin, Owen Austin.

Drawn by: Owen Austin

SKETCH:

## LEGEND

- ⊕ Section Corner—as designated
- 3/4" x 18" rebar set
- x-x-x- Existing fence

