

# GRANT CC NTY Government Land Corner Certificate

TYPE OF MONUMENT: 3/4" x 24" IRON ROD ELEVATION — M.S.L. DATUM: \_\_\_\_\_  
 STATE PLANE COORDINATES: N \_\_\_\_\_ THETA ANGLE: \_\_\_\_\_  
 E \_\_\_\_\_ FIELD BOOK: 827 PAGE 72

## Basis for Monument Location

(Use reverse side if necessary.  
 Show info such as: History of corner, with reference to Vol. and page,  
 dates, surveyor; exact description of monument found; if location  
 computed, by taped or EDM traverse; landowner remarks, witnesses,  
 etc.)

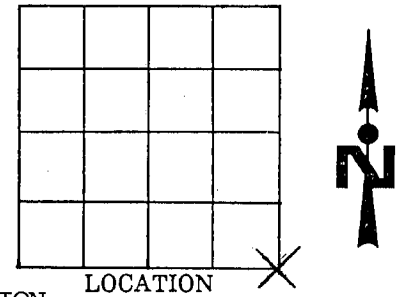

THERE WAS NO INFORMATION ON THE LOCATION OF THE CORNER OR ANY RESTORATION OF THE CORNER SINCE THE ORIGINAL SURVEY WE PERFORMED AN EXSTENSIVE FIELD SEARCH OF THE AREA FOR ANY TYPE OF EVIDENCE. THE ONLY EVIDENCE OF THE CORNER LOCATION WAS AN OLD FENCE INTERSECTION. WE PERFORMED A FIELD TRAVERSE OF THE SECTION AND FOUND THAT THE FENCE INTERSECTION FIT WELL WITH OTHER EVIDENCE WITHIN THE SECTION. I ACCEPTED THE FENCE LOCATION AS THE BEST EVIDENCE TO THE LOCATION OF THE SECTION CORNER AND SET A 3/4"X24" IRON ROD AT THE LOCATION AND MADE WITNESSES.

LOCATION (Indicated by 'X')  
 CITY, VILLAGE or TOWN LITTLE GRANT  
 SECTION 35  
 TOWN 5N  
 RANGE 4W  
 DRAFTED BY W. BULAWA  
 FIELD CREW J. ROLOFF & D. VANDEN HEUVEL

## TIE SKETCH

(Show at least four ties. Also, fence lines,  $\zeta$  of roads, and any other helpful factors and features.)

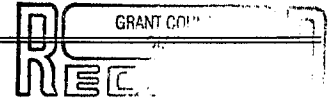
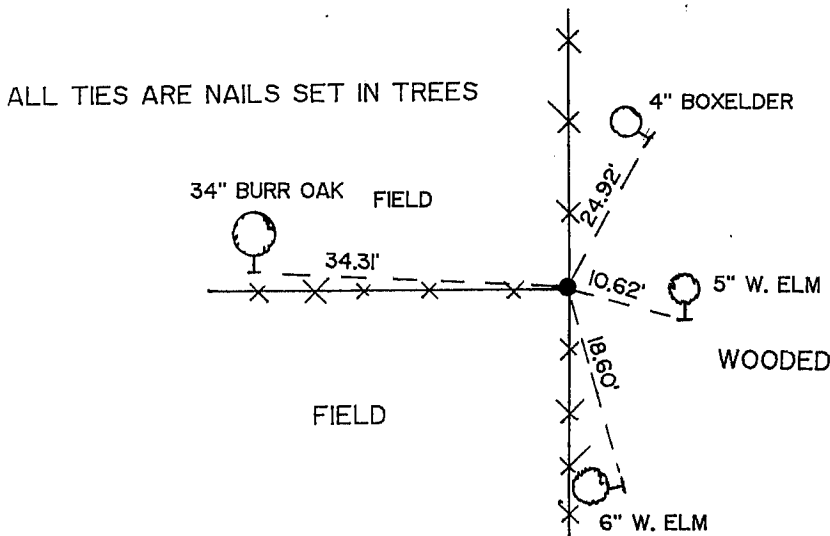

APR 30 1991

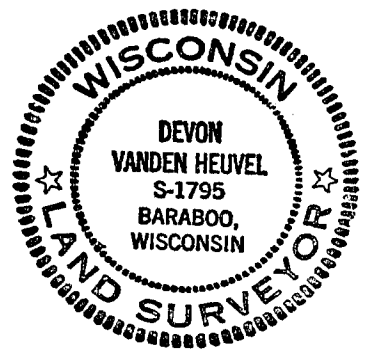

SEAL:

CORNER MAINTENANCE INFO		SEAL:

CERTIFIED CORRECT:

*Devon Vanden Heuvel*  
 Registered Land Surveyor  
 DATE: 4-29-91

For Co. Surveyor Filing Use → CORNER NO. \_\_\_\_\_

123