

U.S. PUBLIC LAND SURVEY MONUMENT RECORD - GRANT COUNTY, WI

Section 3, Town 5 North Range 4 West, Town of Little Grant (a)

NOTE: This form is intended and designed to fulfill all requirements of the Wisconsin Administrative Code Chapter A-E 7.08, U.S. Public Land Survey Monument Record (3) (a) (b) (c) (d) (e) (f) (g) (h) (i).

CERTIFICATE: (i)

I, Aaron J. Austin, Wisconsin Professional Land Surveyor, do hereby certify that the corner location on this record was determined by me and/or under my direct supervision and that this U.S. Public Land Survey Monument Record is correct and complete to the best of my knowledge and belief.

Dated this 20th day of April, 2023.

Aaron J. Austin

Aaron J. Austin, S-2922

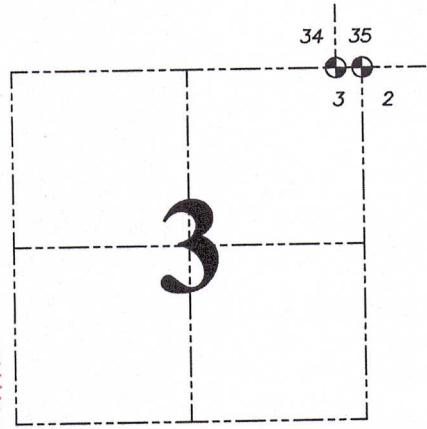
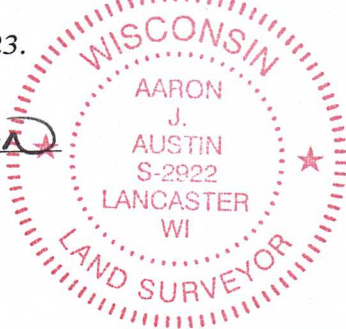

● = CORNER LOCATION

Grant County Coordinates:

NAD 83 (2011)
Northing: 559,044.21
Easting: 788,568.12

HISTORY OF CORNER ESTABLISHMENT:

Original corner was set in 1832 by Sibley.
No other evidence of this corner being set was found.

DESCRIPTION OF CORNER EVIDENCE FOUND: (b) (f) (g) (h)

I set the a 1" x 24" Rebar on the Section line between the North 1/4 corner of Section 2 and the Southeast corner of Section 34, at the recorded offset of 7 links (4.62'). I established four witness corners after I verified the Monument's location with G.P.S. and E.D.M. methods.

DESCRIPTION OF CORNER AND WITNESS MONUMENTS: references and accessories used to perpetuate the original or re-established location of this corner. (c) (d) (e)

Witnesses to corner location Owen Austin, Tanner Austin.
Drawn by: Owen Austin

SKETCH:

LEGEND

- Section Corner—as designated
- 1/2" rebar found
- 3/4" x 18" rebar set
- x-x-x- Existing fence
- ⊙ Existing tree

