

Surveyors of Records

U. S. PUBLIC LAND SURVEY MONUMENT RECORD

Grant County, Wisconsin.

Basis for monument location.

Section 34 T25N, R2W

Researched county survey records and found no evidence of the corner being monumented since the original government survey. Government survey gave reference to a bearing tree at N 25 E, 8, W. Oak 16, at approximately this location stands a 36" Burr Oak. We could not locate any evidence of any W. Oak in the area. It appears to me that the listed Burr Oak was mistaken for a W. Oak in the Government survey and I monumented the corner using the recorded information from the Government Survey.

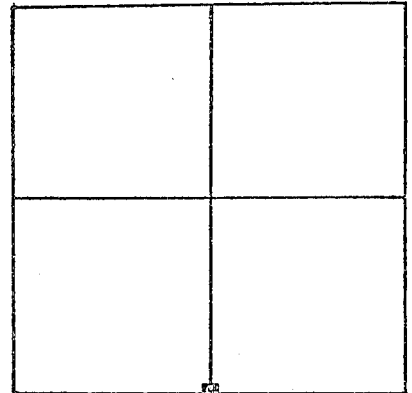

Corner Location
(Indicate by - X)

Tie sketch

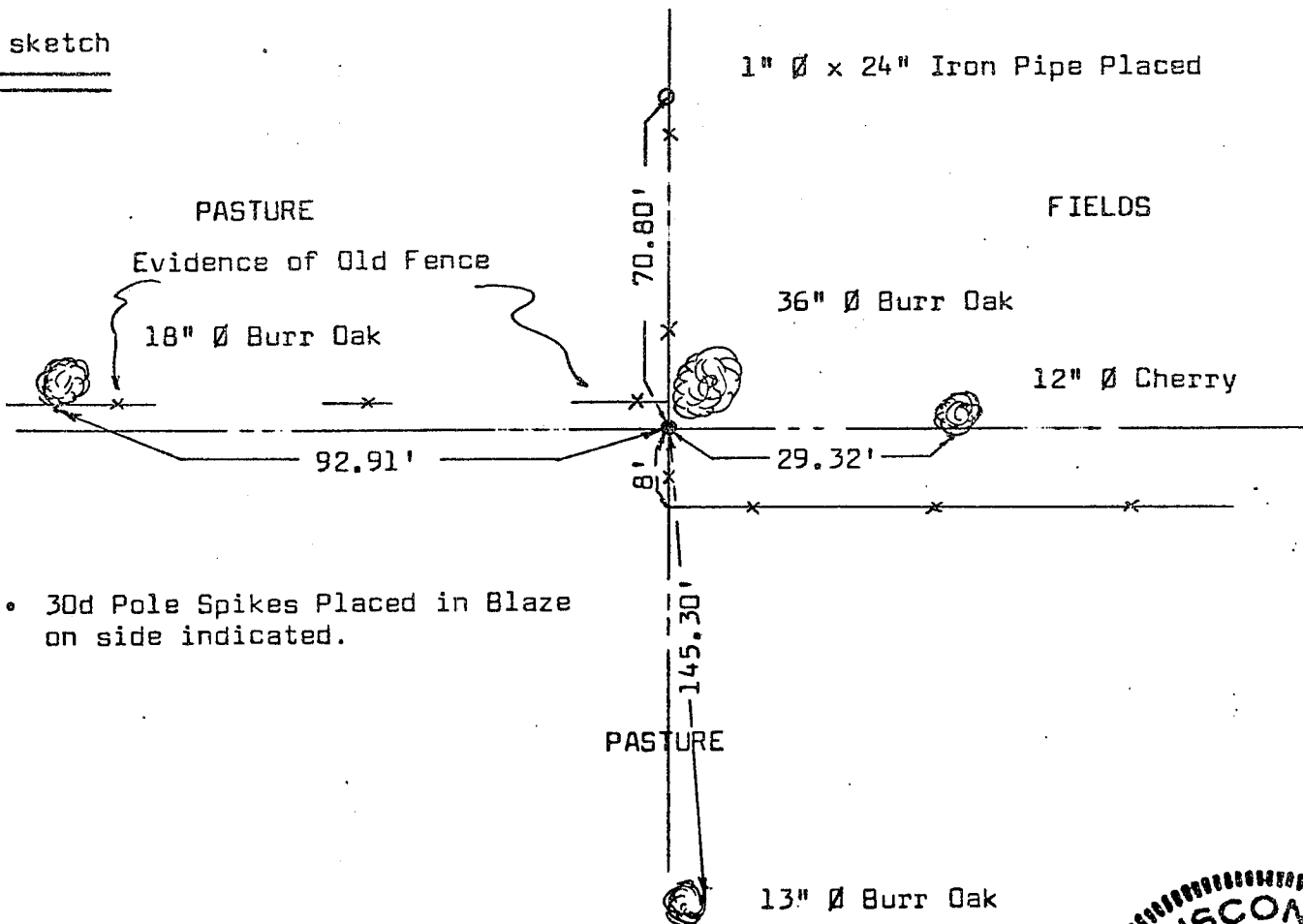

- 30d Pole Spikes Placed in Blaze on side indicated.

I, Matthew J. Janiak Certify that the corner location shown hereon this record was determined by me or under my direction and control and that this U. S. Public Land Survey Monument Record is correct and complete to the best of my knowledge and belief.

9-20-83
Date

Matthew J. Janiak
Registered Land Surveyor

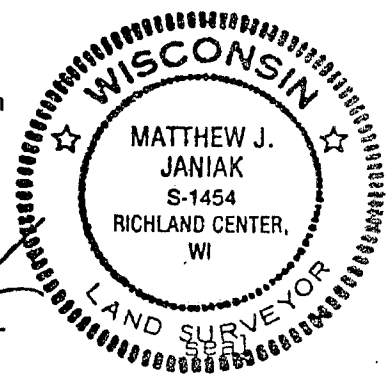

P. 126