

RECORDED

MAR 9 1988

U. S. PUBLIC LAND SURVEY MONUMENT RECORD

GRANT County, Wisconsin.

Basis for monument location.

Corner has been referenced once since the original Government Survey. That reference was of a stone. The corner falls into the grave surface of a town road. No evidence of the stone could be located. The road has been graded down. Established corner from the existing fences, North, South and West. This location fit well with the Section breakdown and I accepted this location as being the most correct.

Section 22, T 5 N, R 2 W

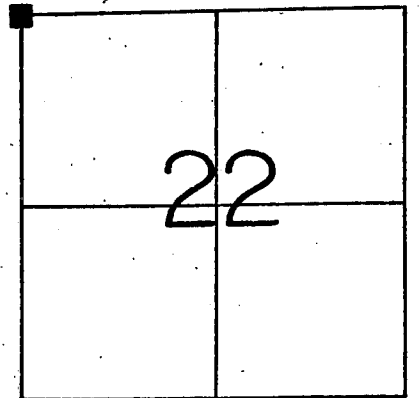

Corner Location (Indicate by - ■)

Tie sketch

TIES: 20d POLE SPIKE SET IN BLAZE AT BOTTOM OF TREE

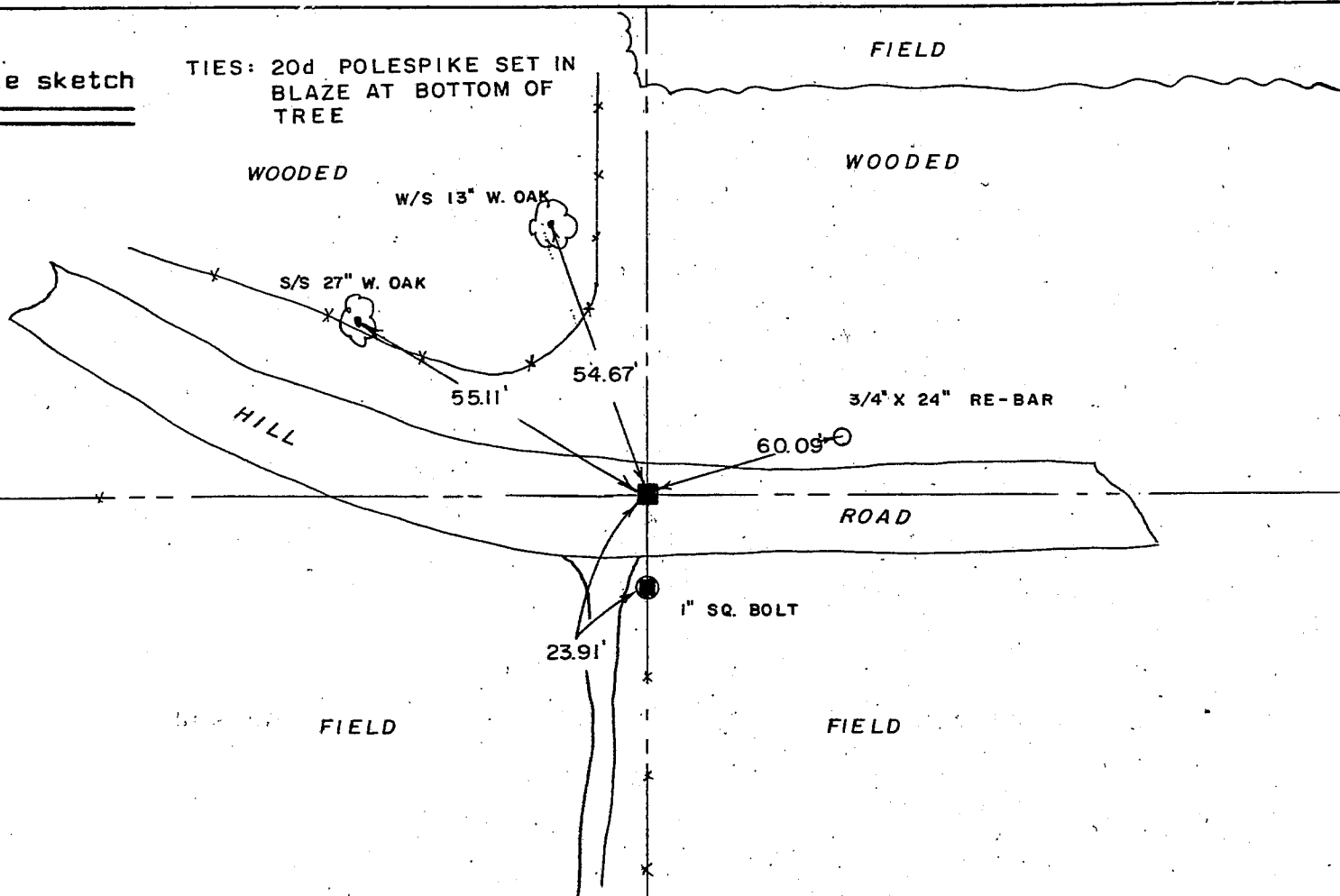

I, _____ Certify that the corner location shown hereon this record was determined by me or under my direction and control and that this U. S. Public Land Survey Monument Record is correct and complete to the best of my knowledge and belief.

3-8-88

Date

Matthew J. Janiak
Registered Land Surveyor

