

GRANT COUNTY

Survey Monument Record

TYPE OF MONUMENT 1 1/2" IRON PIPE FD.
 STATE PLANE COORDINATES: N _____
 E _____
 ELEVATION — M.S.L. DATUM: _____
 THETA ANGLE: _____
 FIELD BOOK: 9504
 PAGE 26

CORNER NO. 59
 SECTION 14
 TOWN 5N
 RANGE 2W
E 1/4 Cor.

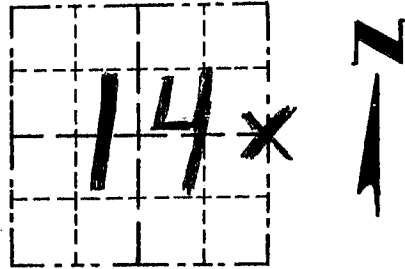

LOCATION
(Indicated by "X")

BASIS FOR MONUMENT LOCATION

(Use reverse side if necessary)

Show info such as: History of corner, with reference to Vol. and pg., dates, surveyor; exact description of monument replaced; if location computed, by taped or EDM traverse; landowner, remarks, etc.

SEAL:

- ORIGINAL CORNER SET IN 1832 BY PARKE
- FOUND A 1 1/2" IRON PIPE AT OCCUPIED SURVEY; CORNER WAS USED 1977 SURVEY BY SCHMIT. I ACCEPTED ITS LOCATION.

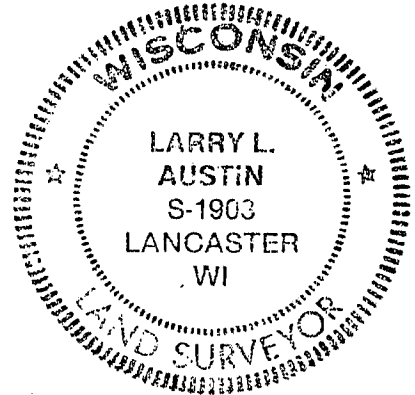

CERTIFIED CORRECT

Larry L. Austin
 Registered Land Surveyor

DATE: 10/24/95

TIE SKETCH

Show at least three (3) ties and monument

