

U.S. PUBLIC LAND SURVEY MONUMENT RECORD - GRANT COUNTY, WI

Section 14, Town 4 North Range 6 West, Town of Glen Haven (a)

NOTE: This form is intended and designed to fulfill all requirements of the Wisconsin Administrative Code Chapter A-E 7.08, U.S. Public Land Survey Monument Record (3) (a) (b) (c) (d) (e) (f) (g) (h) (i).

CERTIFICATE: (i)

I, Aaron J. Austin, Wisconsin Professional Land Surveyor, do hereby certify that the corner location on this record was determined by me and/or under my direct supervision and that this U.S. Public Land Survey Monument Record is correct and complete to the best of my knowledge and belief.

Dated this 24th day of February, 2020.

Aaron J. Austin
Aaron J. Austin, S-2922

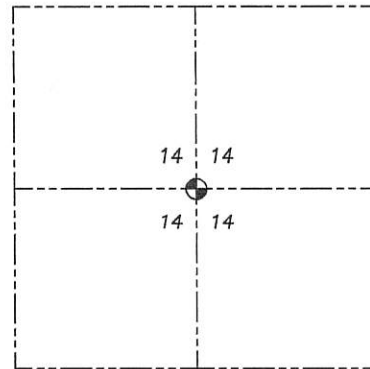
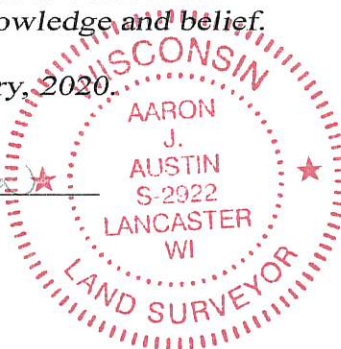

⊕ = CORNER LOCATION

Grant County Coordinates:

NAD 83 (2011)
Northing: 514,302.68
Easting: 728,291.64

HISTORY OF CORNER ESTABLISHMENT:

Original corner was not set with original government survey.
Leo Stuntz tied to the Corner in Survey Book B, Page 136 and 137 dated 9/21/1848.

DESCRIPTION OF CORNER EVIDENCE FOUND: (b) (f) (g) (h)

I set a 3/4" rebar at an occupied fence corner. This location coincides with a projection of a fence along the South line of the North 1/2 of the Northeast 1/4. This location also corresponds with Highway Plan S0201(1). I set four witness corners after I verified the Monument's location with G.P.S. and E.D.M. methods.

DESCRIPTION OF CORNER AND WITNESS MONUMENTS, references and accessories used to perpetuate the original or re-established location of this corner. (c) (d) (e)

Witnesses to corner location Shane Austin, Owen Austin.

Drawn by: Owen Austin

LEGEND

- ⊕ Section Corner—as designated
- 3/4" x 18" rebar set
- x-x-x- Existing fence
- ⊘ Existing utility pole



SKETCH:

