

45093

U.S. PUBLIC LAND SURVEY MONUMENT RECORD - GRANT COUNTY, WI

Section 30, Town 4 North Range 5 West, Town of Glen Haven (a)

NOTE: This form is intended and designed to fulfill all requirements of the Wisconsin Administrative Code Chapter A-E 7.08, U.S. Public Land Survey Monument Record (3) (a) (b) (c) (d) (e) (f) (g) (h) (i).

CERTIFICATE: (i)

I, Aaron J. Austin, Wisconsin Professional Land Surveyor, do hereby certify that the corner location on this record was determined by me and/or under my direct supervision and that this U.S. Public Land Survey Monument Record is correct and complete to the best of my knowledge and belief.

Dated this 17th day of July, 2019.

Aaron J. Austin
Aaron J. Austin, S-2922

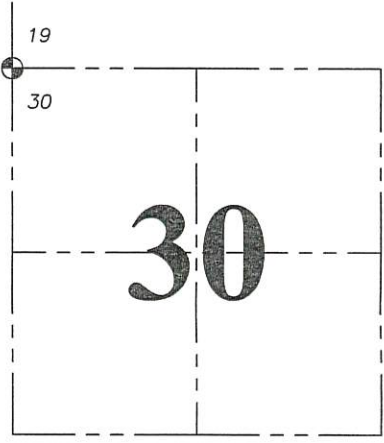
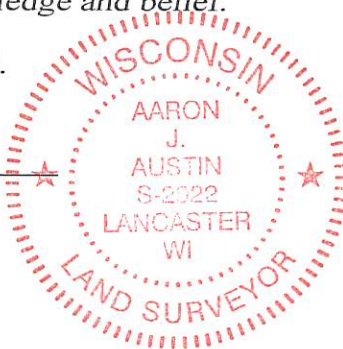

⊕ = CORNER LOCATION

Grant County Coordinates:
NAD 83 (2011)
Northing: 506,341.19
Easting: 736,406.99

HISTORY OF CORNER ESTABLISHMENT:
Original corner was set in 1832 by Sibley.

DESCRIPTION OF CORNER EVIDENCE FOUND: (b) (f) (g) (h)
I set a 3/4" rebar on the East line of Section 25 at the recorded distance of 147 links South of Northeast corner of Section 25. G.P.S. and E.D.M. methods were utilized in the establishment of the corner.

DESCRIPTION OF CORNER AND WITNESS MONUMENTS, references and accessories used to perpetuate the original or re-established location of this corner. (c) (d) (e)
Witnesses to corner location Shane Austin, Owen Austin.
Drawn by: Owen Austin

SKETCH:

