

45085
~~4085~~

U.S. PUBLIC LAND SURVEY MONUMENT RECORD

(AS REQUIRED BY s.A-E 7.08, WI. ADM. CODE)

HISTORY OF ORIGINAL CORNER ESTABLISHMENT AND SUBSEQUENT RESTORATIONS AND DESCRIPTION OF ANY RECORD, MONUMENT, OCCUPATION, TESTIMONIAL OR OTHER EVIDENCE CONSIDERED

I did not find any records for the SE corner except for the Original Survey. I accepted a point 0.5' south of a wood corner post, the fence lines running E-W-N from the corner post

COORDINATES ARE ESTABLISHED TO THE CORNER AND WITNESS TIES AS SHOWN BELOW BEARING REFERENCE AND COORDINATES ARE GRANT COUNTY COORDINATE SYSTEM NAD 83(91) ENGLISH SYSTEM

N= 506202.25
E= 757715.58

CORNER WAS: (CHECK ALL THAT APPLY)

- RESTORED THROUGH ACCEPTANCE OF AN OBLITERATED EVIDENCE LOCATION
- RESTORED THROUGH ACCEPTANCE OF A FOUND PERPETUATED LOCATION CONSIDERED A LOST CORNER AND REESTABLISHED THROUGH LOST CORNER PROPORTIONATE METHODS (INCLUDE A PLAN VIEW DRAWING SHOWING BEARING & DISTANCE TO OTHER PUBLIC LAND SURVEY CORNERS USED FOR PROPORTIONING AND DETERMINING THE CORNER LOCATION)
- RESTORED OR REESTABLISHED IN A LOCATION THAT DIFFERS FROM A PREVIOUS RESTORATION OR REESTABLISHMENT (INCLUDE A PLAN VIEW DRAWING AND INDICATE WHAT WAS SET AND/OR FOUND)

Describe the monument and accessories used to perpetuate the location of the corner. (include a plan view drawing and indicated what was set and/or found)

LEGEND:

- △ SET 5/8"φ REBAR TIE
- FOUND STONE MONUMENT
- ⊗ FOUND REBAR WITH GRANT CO. ALUM CAP
- SET 7/8"X24" REBAR WITH GRANT CO. ALUM CAP
- () RECORDED AS
- ⊗ FD. RING SHANK NAIL
- FENCE
- ▲ FOUND 1" IRON PIPE

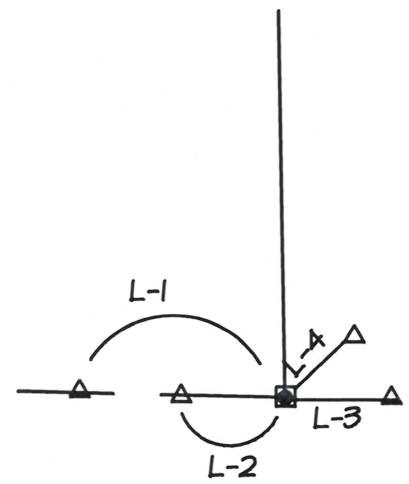

SECT <u>22</u>	SECT <u>23</u>
TOWN <u>4</u> N	TOWN <u>4</u> N
RANGE <u>5W</u>	RANGE <u>5W</u>
SECT <u>27</u>	SECT <u>26</u>
TOWN <u>4</u> N	TOWN <u>4</u> N
RANGE <u>5W</u>	RANGE <u>5W</u>

- L-1 N 88°24'29" W 43.01'
- L-2 N 89°26'30" W 21.75'
- L-3 S 89°38'32" E 22.26'
- L-4 N 48°59'21" E 19.15'

● = LOCATION OF CORNER

THE SE COR. OF SECT 22 T 4 N, R 5W

THE NE COR. OF SECT 27 T 4 N, R 5W

THE NW COR. OF SECT 26 T 4 N, R 5W

THE SW COR. OF SECT 23 T 4 N, R 5W

LAFAYETTE COUNTY, WISCONSIN

JOB ID: 185-046 BOOK #: 2017-1 P.43

I, LAURENCE E SCHMIT CERTIFY THAT THE CORNER LOCATION SHOWN ON THIS RECORD WAS DETERMINED BY ME OR UNDER MY DIRECTION AND CONTROL AND THAT THIS U.S. PUBLIC LAND SURVEY MONUMENT RECORD IS CORRECT AND COMPLETE TO THE BEST OF MY KNOWLEDGE AND BELIEF.

Laurence E Schmit 9-30-18

SIGNATURE

DATE:

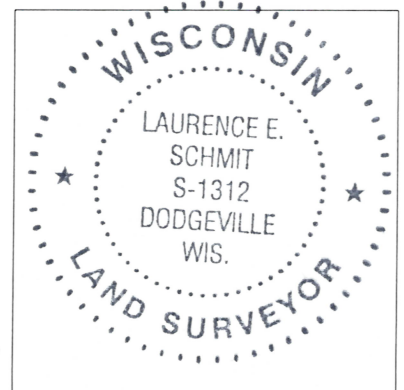

LAND SURVEYORS SEAL

INDEX NUMBER 85