

Survey Monument Record

TYPE OF MONUMENT 3/4" X 24" IRON  
BAR SET

CORNER NO. 25  
SECTION 3  
TOWN 4N  
RANGE 5W

FIELD BOOK: 97-20  
PAGE \_\_\_\_\_

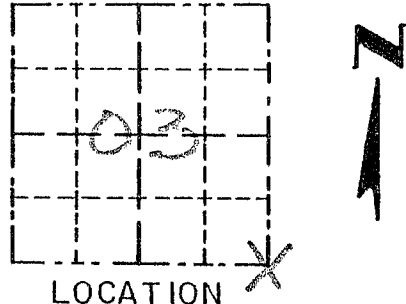

LOCATION  
(Indicated by "X")

BASIS FOR MONUMENT LOCATION

(Use reverse side if necessary)

Show info such as: History of corner; with reference to Vol. and pg., dates, surveyor; exact description of monument replaced; if location computed, by taped or EDM traverse; landowner, remarks, etc.

CORNER SET IN 1832 BY ROBERT CLARK, NO RECORD OF CORNER FOUND SINCE ORIGINAL SURVEY. CORNER WAS SET AT AN OCCUPIED LOCATION, NORTHING SET BY EAST/WEST ROAD. EASTING SET BY A FENCE SOUTH. VERIFIED ITS LOCATION USING EDM METHODS.

SEAL:

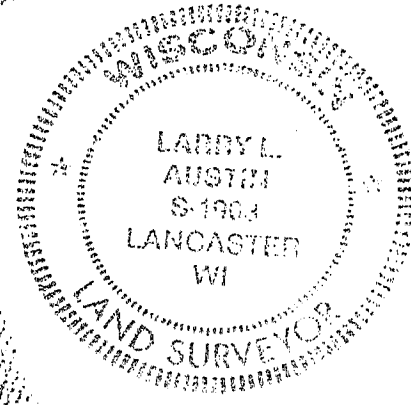

CERTIFIED CORRECT

*Larry L. Austin*  
Registered Land Surveyor

DATE: 12/31/97

TIE SKETCH

Show at least three (3) ties and monument

LEGEND

- ⊕ 3/4" X 24" IRON BARSET
- 1/2" X 15" IRON BAR SET
- XX EXISTING FENCE

