

Survey Monument Record

TYPE OF MONUMENT 1/2" Iron Rod
 STATE PLANE COORDINATES: N _____
 E _____
 ELEVATION — M.S.L. DATUM: _____
 THETA ANGLE: _____
 FIELD BOOK: 95-9 ties set by BPRR
 PAGE _____

CORNER NO. _____ JUL 11 1996
 SECTION 18
 TOWN 4N
 RANGE 4W

BASIS FOR MONUMENT LOCATION

(Use reverse side if necessary)
 Show info such as: History of corner, with reference to Vol. and pg., dates, surveyor; exact description of monument replaced; if location computed, by taped or EDM traverse; landowner, remarks, etc.

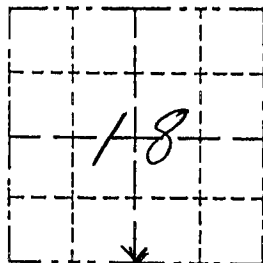

LOCATION
(Indicated by "X")

- FOUND PERPETUATED LOCATION
- OBLITERATED EVIDENCE LOCATION
- LOST CORNER (RESTORED BY PROPORTIONATE METHODS)

There are no recent survey records of this corner. The occupied location of an E-W road centerline in line with a fence to the north was accepted as the corner location after it fell nearly on line with the restored SW and occupied SE corners and the relationships to adjacent 40 corners were ballanced. The relationships fit survey records from the mid 1800's.

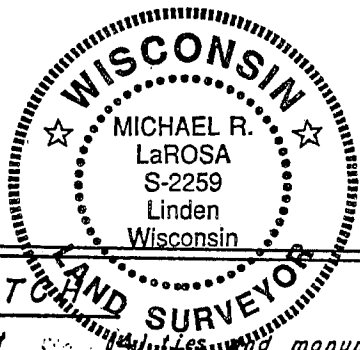

CERTIFIED CORRECT TO THE BEST OF MY KNOWLEDGE AND BELIEF

Michael R. LaRosa
 Registered Land Surveyor

DATE: 6/18/1996

TIE SKETCH

Show at least _____ monument

