

GRANT COUNTY

Survey Monument Record

TYPE OF MONUMENT COUNTY MONUMENT SET

STATE PLANE COORDINATES: N _____
E _____

ELEVATION — M.S.L. DATUM: _____

THETA ANGLE: _____

FIELD BOOK: _____

PAGE _____

CORNER NO. 92
SECTION 30
TOWN 4 N
RANGE 4 W
N 1/4 COR

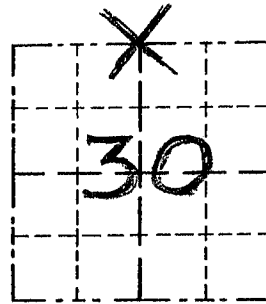

LOCATION
(Indicated by "X")

BASIS FOR MONUMENT LOCATION

(Use reverse side if necessary)

Show info such as: History of corner, with reference to Vol. and pg., dates, surveyor; exact description of monument replaced; if location computed, by taped or EDM traverse; landowner, remarks, etc.

SEAL:

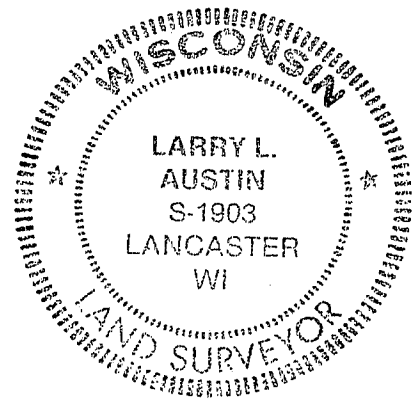

CORNER WAS ORIGINALLY SET IN 1833 BY ROBERT CLARK. NO RECORD FOUND SINCE ORIGINAL SURVEY. E-W LOCATION ESTABLISHED BY PROPORTIONATE METHODS & N-S LOCATION ESTABLISHED FROM PROJECTION OF E-W FENCE FROM THE EAST. THIS LOCATION MATCHES THE 1848 PLAT OF BEETOWN; THIS LOCATION WELL WITH OCCUPATION IN PLAT OF BEETOWN & WITH THE 1848 N-S 1/4 LINE MEASUREMENT.

CERTIFIED CORRECT

Larry L. Austin
Registered Land Surveyor

DATE: 12-8-94

TIE SKETCH

Show at least three (3) ties and monument

