

U.S. PUBLIC LAND SURVEY MONUMENT RECORD - GRANT COUNTY, WI

Section 19, Town 4 North Range 4 West, Town of Bloomington East

CERTIFICATE:

I, John R. Huseman, do hereby certify that the corner location on this record was determined by me and/or under my direct supervision and that this U.S. Public Land Survey Monument Record is correct and complete to the best of my knowledge and belief.

Dated this 31st day of October, 2012.

John R. Huseman
John R. Huseman, RLS-1631-8

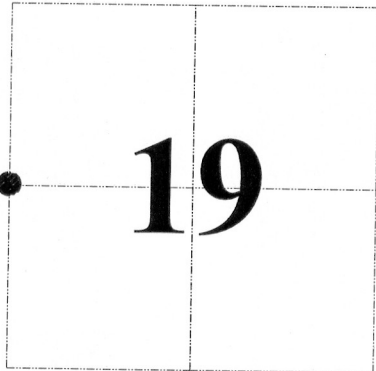
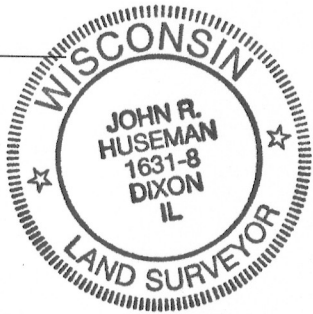

● = CORNER LOCATION

HISTORY OF CORNER ESTABLISHMENT:

No monumentation or recorded data was found for this corner.

DESCRIPTION OF CORNER EVIDENCE FOUND:

Corner set by proration between the existing northwest and southwest section corners and proportional measurement from the east quarter corner and center of section. The location fits occupation. Location verified by GPS and Total Station measurement.

DESCRIPTION OF CORNER AND WITNESS MONUMENTS, references and accessories used to perpetuate the original or re-established location of this corner. Witnesses to corner location Ben Scheffner and Rey Munoz

SKETCH:

⊗ = 3/4" x 36" Rebar Set

