

44048

# U.S. PUBLIC LAND SURVEY MONUMENT RECORD - GRANT COUNTY, WI

Section 16, Town 4 North Range 4 West, Town of Beetown (a)

NOTE: This form is intended and designed to fulfill all requirements of the Wisconsin Administrative Code Chapter A-E 7.08, U.S. Public Land Survey Monument Record (3) (a) (b) (c) (d) (e) (f) (g) (h) (i).

### CERTIFICATE: (i)

I, Aaron J. Austin, Wisconsin Professional Land Surveyor, do hereby certify that the corner location on this record was determined by me and/or under my direct supervision and that this U.S. Public Land Survey Monument Record is correct and complete to the best of my knowledge and belief.

Dated this 16th day of November, 2019.

*Aaron J. Austin*  
Aaron J. Austin, S-2922

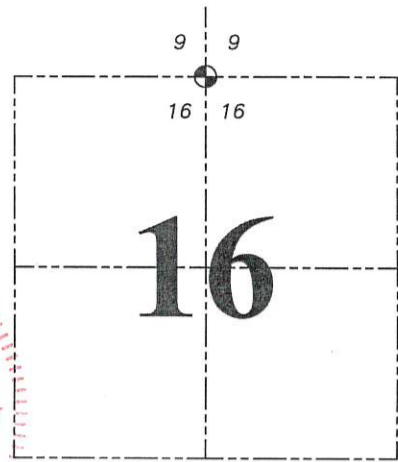
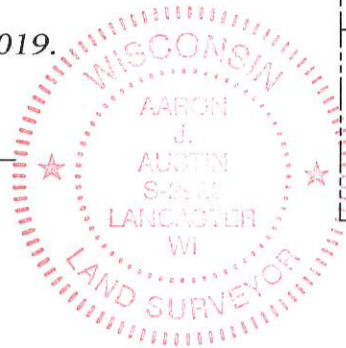

☉ = CORNER LOCATION

Grant County Coordinates:  
NAD 83 (2011)  
Northing: 516,697.84  
Easting: 780,857.38

### HISTORY OF CORNER ESTABLISHMENT:

Original corner was set in 1833 by Robert Clark.

### DESCRIPTION OF CORNER EVIDENCE FOUND: (b) (f) (g) (h)

I set a 7/8" rebar midway and on line between Northwest of Section 16 and Northeast of Section 16. I set four witness corners after I verified the monument's location with G.P.S. and E.D.M. methods

### DESCRIPTION OF CORNER AND WITNESS MONUMENTS:

references and accessories used to perpetuate the original or re-established location of this corner. (c) (d) (e)

Witnesses to corner location Shane Austin, Owen Austin.  
Drawn by: Owen Austin

**RECEIVED**

By Land Information Office at 12:44 pm, Feb 26, 2020

SKETCH:

## LEGEND

- ☉ Section Corner—as designated
- 3/4" x 18" rebar set
- All ties buried 18"±

NORTHWEST CORNER  
SECTION 16, T4N R4W  
3/4" Rebar found

NORTHEAST CORNER  
SECTION 16, T4N R4W  
2" Iron pipe found

NORTH 1/4 CORNER  
SECTION 16, T4N R4W  
7/8" x 24" Rebar set  
Buried 18"±

