

U.S. PUBLIC LAND SURVEY MONUMENT RECORD - GRANT COUNTY, WI

Section 1, Town 4 North Range 4 West, Town of Beetown (a)

NOTE: This form is intended and designed to fulfill all requirements of the Wisconsin Administrative Code Chapter A-E 7.08, U.S. Public Land Survey Monument Record (3) (a) (b) (c) (d) (e) (f) (g) (h) (i).

CERTIFICATE: (i)

I, Aaron J. Austin, Wisconsin Professional Land Surveyor, do hereby certify that the corner location on this record was determined by me and/or under my direct supervision and that this U.S. Public Land Survey Monument Record is correct and complete to the best of my knowledge and belief.

Dated this 10th day of May, 2022.

Aaron J. Austin
Aaron J. Austin, S-2922

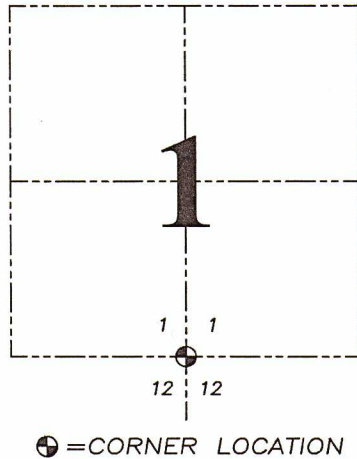
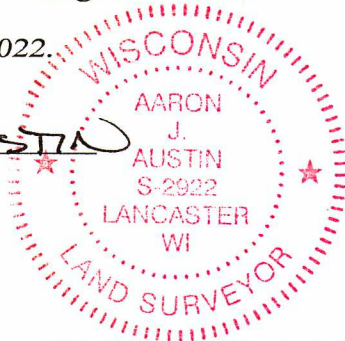

Grant County Coordinates:
NAD 83 (2011)
Northing: 521,989.12
Easting: 796,772.67

HISTORY OF CORNER ESTABLISHMENT:

Original corner was set in 1833 by Robert Clark.
John Buser prepared a Survey dated 10/15/1928 filed in Book GCA, Page 637 and showed a Stone Monument.

DESCRIPTION OF CORNER EVIDENCE FOUND: (b) (f) (g) (h)

I found a 2" Iron Pipe disturbed. I reset the Corner based upon the 3/4" Rebar found at the Southwest Corner of Section 1, through a 1" Iron Pipe found on a Survey by Homer Ralph Jr in Book: E Page: 205 and utilizing the recorded distance of 127.5' from the house corner per a Survey by John T. Buser in Book: GCA, Page: 637. I set four witness corners after I verified the Monument's location with G.P.S. and E.D.M. methods.

DESCRIPTION OF CORNER AND WITNESS MONUMENTS, references and accessories used to perpetuate the original or re-established location of this corner. (c) (d) (e)

Witnesses to corner location Shane Austin, Owen Austin, Tanner Austin.
Drawn by: Owen Austin

SKETCH:

LEGEND

- ⊕ Section Corner—as designated
- 5/8" x 18" rebar set
- ⊘ Existing utility pole
- △ 1" diameter iron pipe found

