

42020

U.S. PUBLIC LAND SURVEY MONUMENT RECORD - GRANT COUNTY, WI

Section 1, Town 4 North Range 2 West, Town of Ellenboro (a)

NOTE: This form is intended and designed to fulfill all requirements of the Wisconsin Administrative Code Chapter A-E 7.08, U.S. Public Land Survey Monument Record (3) (a) (b) (c) (d) (e) (f) (g) (h) (i).

CERTIFICATE: (i)

I, Aaron J. Austin, Wisconsin Professional Land Surveyor, do hereby certify that the corner location on this record was determined by me and/or under my direct supervision and that this U.S. Public Land Survey Monument Record is correct and complete to the best of my knowledge and belief.

Dated this 19th day of June, 2018.

Aaron J. Austin
Aaron J. Austin, S-2922

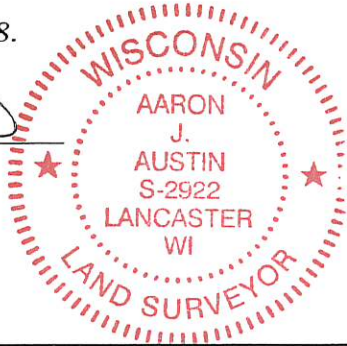

Grant County Corner I.D. 42020

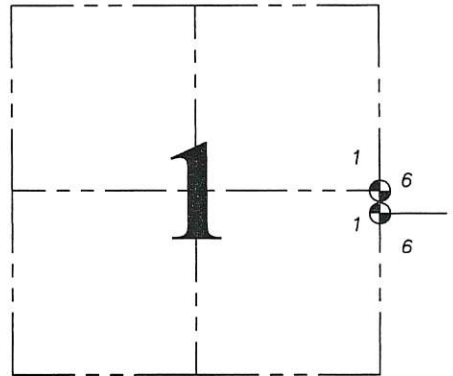

⊕ = CORNER LOCATION

Grant County Coordinates:
NAD 83 (2011)
Northing: 524,318.46
Easting: 863,031.01

HISTORY OF CORNER ESTABLISHMENT:

1832-Sibley set the original corner.

DESCRIPTION OF CORNER EVIDENCE FOUND: (b) (f) (g) (h)

I reset the corner on the East line of Section 1 at the recorded offset of 1.48 chains North of the West 1/4 corner of Section 6, T4N R1W as established by Barber on a Survey filed in Book D, Page 14 in 1877. I set four witness corners after I verified it's location with G.P.S. and E.D.M. methods

DESCRIPTION OF CORNER AND WITNESS MONUMENTS, references and accessories used to perpetuate the original or re-established location of this corner. (c) (d) (e)

Witnesses to corner location Shane Austin, Owen Austin.

LEGEND

- ⊕ Section Corner—as designated
- 3/4" x 18" rebar set with cap
- Section line
- - - Centerline

SKETCH:

