

Survey Monument Record

TYPE OF MONUMENT COUNTY MONUMENT  
STATE PLANE COORDINATES: N \_\_\_\_\_  
E \_\_\_\_\_  
ELEVATION — M.S.L. DATUM: \_\_\_\_\_  
THETA ANGLE: \_\_\_\_\_  
FIELD BOOK: \_\_\_\_\_  
PAGE \_\_\_\_\_

CORNER NO. 6  
SECTION 3  
TOWN 4 N  
RANGE 2 W  
N 1/4 COR

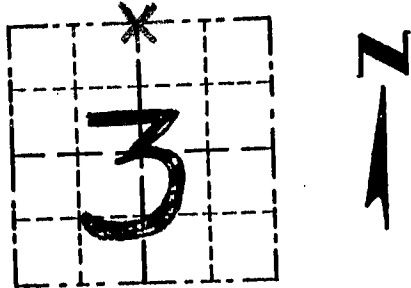

LOCATION  
(Indicated by "X")

BASIS FOR MONUMENT LOCATION

(Use reverse side if necessary)

Show info such as: History of corner, with reference to Vol. and pg., dates, surveyor; exact description of monument replaced; if location computed, by taped or EDM traverse; landowner, remarks, etc.

NE & NW COR. ORIGINALLY SET IN 1833  
BY R. CLARK; NO RECORD FOUND  
OF THE CORNER SINCE THE  
ORIGINAL SURVEYS; I SET  
THE CORNER ON THE SOUTH LINE  
OF SEC 34 & AT THE PROPOR  
TIONED DIST FROM A FOUND PIPE  
AT THE S 1/4 COR. OF SEC. 34

SEAL:

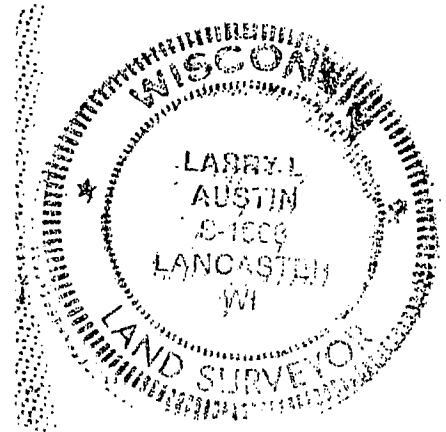

CERTIFIED CORRECT

Larry L. Austin  
Registered Land Surveyor  
DATE: 2/16/95

TIE SKETCH

Show at least three (3) ties and monument

LEGEND

- GRANT COUNTY ALUM. MONUMENT
  - 1/2" REBAR
  - 1" IRON PIPE FD.
  - ⊙ 30d POLE SPIKE FD. IN OAK TREE
  - \*-\* EXISTING FENCE
- 1983 JANIAK SURVEY

