

# U.S. PUBLIC LAND SURVEY MONUMENT RECORD - GRANT COUNTY, WI

Section 5, Town 4 North Range 1 West, Town of Lima(a)

NOTE: This form is intended and designed to fulfill all requirements of the Wisconsin Administrative Code Chapter A-E 7.08, U.S. Public Land Survey Monument Record (3) (a) (b) (c) (d) (e) (f) (g) (h) (i).

**CERTIFICATE: (i)**

I, Aaron J. Austin, Wisconsin Professional Land Surveyor, do hereby certify that the corner location on this record was determined by me and/or under my direct supervision and that this U.S. Public Land Survey Monument Record is correct and complete to the best of my knowledge and belief.

Dated this 22nd day of November, 2016.

*Aaron J. Austin*  
 Aaron J. Austin, S-2922

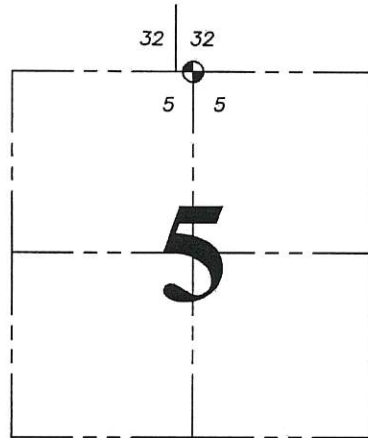
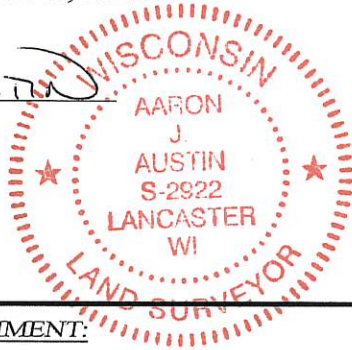

⊙ = CORNER LOCATION

Corner No. 010

HISTORY OF CORNER ESTABLISHMENT:

Corner was not set with original surveys.  
 No other record was found for the corner.

DESCRIPTION OF CORNER EVIDENCE FOUND: (b) (f) (g) (h)

I reset the corner at the proportional offset of 67.65 feet from the South 1/4 corner of Section 32, T5N R1W and online with the Southeast corner of Section 32, T5N R1W. This also coincides with a Section Summary prepared by Larry Austin dated 8-5-2003. I verified its location with G.P.S. and E.D.M. methods.

DESCRIPTION OF CORNER AND WITNESS MONUMENTS, references and accessories used to perpetuate the original or re-established location of this corner. (c) (d) (e)

Witnesses to corner location: Shane Austin, Owen Austin.

SKETCH:

