

# U. S. PUBLIC LAND SURVEY MONUMENT RECORD

**INSTRUCTIONS :** This record shall show the location of the corner and shall include all of the following nine elements (a through i).

- (a) Identify the corner by reference to the U.S. public land survey system.  
 ● = Corner monument restored.

E1/4 Corner of Section 27

T 3 N R 4 W

Town of Waterloo

Grant Co., Wis.

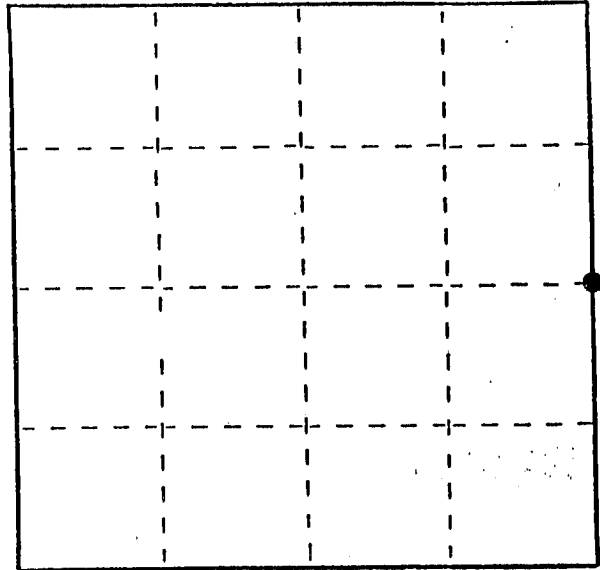

Section 27 T3N R4W

- (b) Describe any record evidence, monument evidence, occupational evidence, testimonial evidence or any other material evidence you considered, and whether the monument was found or placed. Originally set by Lucius Lyon in the 1st 1/4 of 1833. In November, 1841, James E. Freeman did a survey in the West 1/2 of Section 26, tying into the corner, but gives no ties, or other pertinent information. No other record found. An EDM traverse of the Section shows a line extended from the West 1/4 corner across the fenceline and iron pipe by Krohn near center of Sec., intersected with a line from the SE corner North across the existing 40 line fence corner gives almost exactly (within inches) the same distance from this corner to 40 corner as 40 corner to SE corner. Corner was set at this point.

- (c) In the plan view drawing below, provide reference ties to at least 4 witness monuments, or, if the location is within a municipality, to at least 2 witness monuments. (Witness monuments shall be made of concrete, natural stone, iron or other equally durable material.) Describe witness monuments.

- (d) Show a plan view drawing depicting the relevant monuments and reference ties which is sufficient in detail to enable accurate relocation of the corner monument if the corner monument is disturbed. Indicate north.

Scale: 1" = 40'

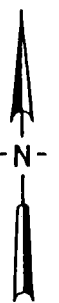

(Bearings shown are for orientation purposes only)

- 1= 18" Maple N10°W 10.52'
- 2= 16" Maple N70°E 32.33'
- 3= 12" Maple S25°E 26.65'
- 4= 12" Maple S80°W 20.65'

All trees blazed & 60# spike set in base

Corner is a 3/4" X 6" star drill hole in solid bedrock; 3/4" Iron Bar with plastic ID. cap placed in hole; bedrock 18" under surface.

Also set sign and post

very old and crooked fenceline meanders from a point N70°W 125' from corner, along North side of ditch, and Southeasterly to river.

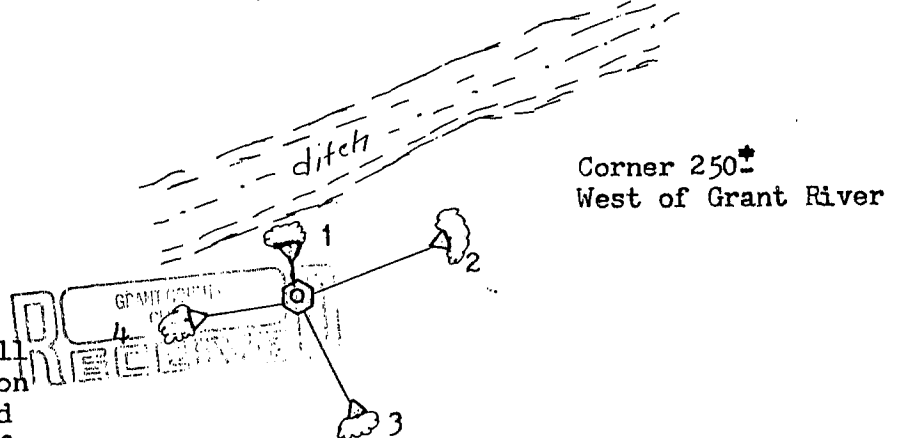

SEP 13 1989

*[Handwritten signature]*

- (e) Describe any material discrepancy between the location of the corner as restored or reestablished and the location of that corner as previously restored or reestablished by distance and direction. Show the discrepancy on the plan view drawing under (d), above. Show the distances between the corner as previously restored or reestablished and (1) the corner as restored or reestablished, and (2) to at least 2 of the witness monuments shown on the drawing in (d), above.

NONE

- (f) Was the corner restored through acceptance of (1) an obliterated evidence location, or, (2) a found perpetuated location?

Obliterated evidence location

- (g&h) Was the corner reestablished through lost corner proportionate methods? If so, show the method, including the directions and distances to other public land survey corners used as evidence or used for proportioning in determining the corner location?

NO

- (1) I, F. Curtis Crook  
(type or print name) certify that the corner location shown on this record was determined by me or under my direction and control and that this U.S. Public Land Survey Monument Record is correct and complete to the best of my knowledge and belief.

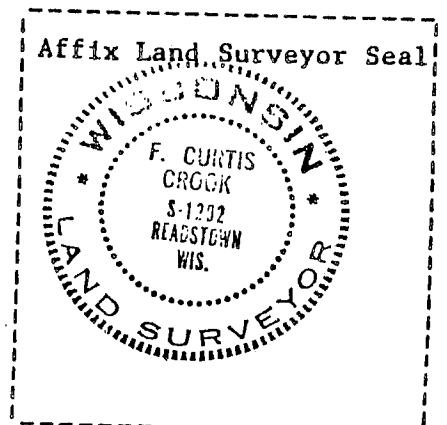

*F. Curtis Crook* 5-25-89