

Survey Monument Record

TYPE OF MONUMENTS 3/4 REPAIRS w/ Grant County Aluminum Caps

STATE PLANE COORDINATES: N _____
E _____

ELEVATION — M.S.L. DATUM: _____

THETA ANGLE: _____

FIELD BOOK: _____

PAGE _____

CORNER NO. _____
SECTION W 1/4 30 E 1/4 25
TOWN 3N 3N
RANGE 3W 4W

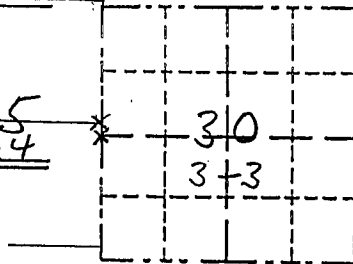

BASIS FOR MONUMENT LOCATION

(Use reverse side if necessary)

Show info such as: History of corner, with reference to Vol. and pg., dates, surveyor; exact description of monument replaced; location computed, by taped or EDM traverse; landowner, remarks, etc.

LOCATION
(Indicated by "X")

- FOUND PERPETUATED LOCATION
- OBLITERATED EVIDENCE LOCATION
- LOST CORNER (RESTORED BY PROPORTIONATE METHODS)

There are no recent survey records of these corners. There are several area surveys, recorded and unrecorded, by Cejka, Brashaw, Orth, Shoenthard, Gensken and myself that relate to some of these lines. Occupational evidence as well as the Cejka survey were used to determine the eastings of the corners. A survey by Brashaw dated 12/22/1985 yielded the northings of the NW corner of 30-3-3. This was used along with strong physical evidence at the SW of 30-3-3 and SE of 25-3-4 to determine the northings of the restored corners. These corners fit physical evidence as well as an 1897 survey by Sampson in 30-3-3 extremely well. The unrecorded and deficient surveys by Brashaw

CERTIFIED CORRECT TO THE BEST OF MY KNOWLEDGE AND BELIEF

Michael R. LaRosa
Registered Land Surveyor

DATE: 12/22/97

TIE SKETCH and Shoenthard in Section 25 provided no useful measurements and do not fit these corners well.

Show at least (4) ties and monument

- A-B S 0° 55' 13" W 58.79'
- A-C N 61° 12' 12" W 30.40'
- A-D S 4° 50' 07" E 175.05'
- A-E S 18° 35' 40" E 195.36'
- A-F S 31° 36' 22" E 170.83'
- B-C N 19° 17' 23" W 77.79'
- B-D S 7° 43' 50" E 116.71'
- B-E S 26° 34' 55" E 141.32'
- B-F S 46° 12' 57" E 125.32'

