

GRANT COUNTY CERTIFIED LAND CORNER

CORNER NUMBER 08

CERTIFICATE:

I, Larry L. Austin, do hereby certify that on the 11th day of November, 1995, I found no evidence of the North 1/4 corner of Section 4, Town 3 North, Range 2 West, of the 4th Principal Meridian, and I re-established said corner according to the Wisconsin statutes as shown and described hereon.

Dated this 9th day of June, 2000

Larry L. Austin
Larry L. Austin S-1903

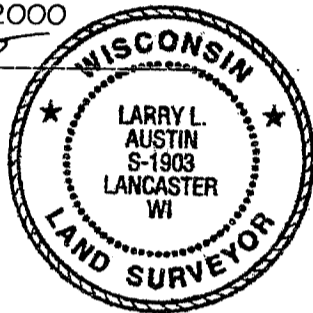

SEAL

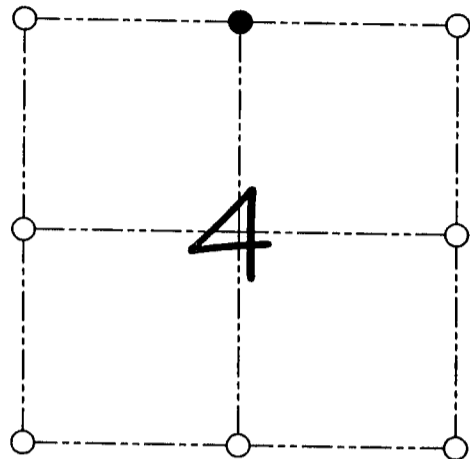

● = CORNER LOCATION
NORTH 1/4 CORNER OF SECTION 4, T 3 N R 2 W TOWN OF HARRISON

HISTORY OF ORIGINAL CORNER ESTABLISHMENT:

Corner was never originally set. Corner was tied 1855 by Overton no mention of a monument.

DESCRIPTION OF CORNER EVIDENCE FOUND:

I found no evidence of the location of the corner. I set the corner at the proportioned offset from the South 1/4 of Section 33. Verified this location using E.D.M. methods.

DESCRIPTION OF CORNER AND WITNESS MONUMENTS, references and accessories used to perpetuate the original or re-established location of this corner

WITNESS TO THE CORNER LOCATION: BOBBY SEDGWICK

SKETCH:

LEGEND

- Grant County aluminum monument set
- Number 4 by 24" rebar set with red plastic cap
- x— Existing fence location

